

# DESIGN DRAWING

REVISIONS			
REV	DESCRIPTION	DATE	BY
A	PER CO #1	7/26/07	DLS

**NOTE 1:** Do not scale drawing. This drawing is for general truck configuration only. All items and dimensions shown are approximate and may vary with final production. The drawing may not provide illustration for all items in the specification. In all situations where the drawing may contradict the specifications, the specifications shall prevail. This drawing and all data herein are provided as confidential materials and shall not be reproduced without written consent of the manufacturer.

**NOTE 2:** Chassis frame height will change due to axle characteristics, loading and the dimensions which will effect the overall height dimension shown. Any overall height restrictions should take this into consideration and allow approximately 2-3 inches of tolerance.

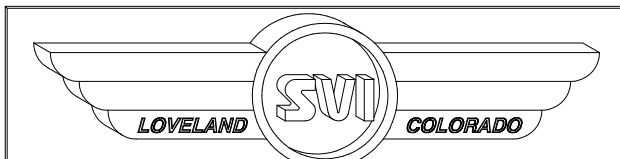
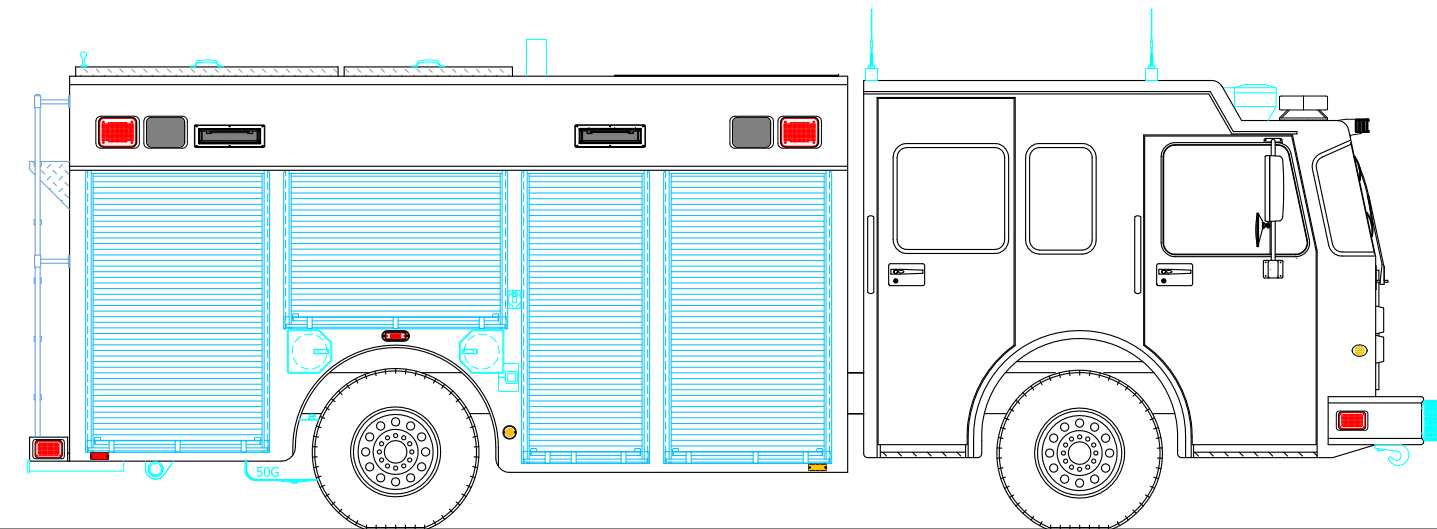
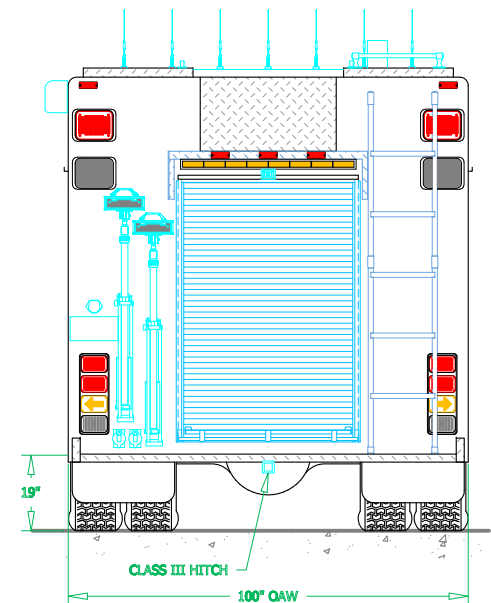
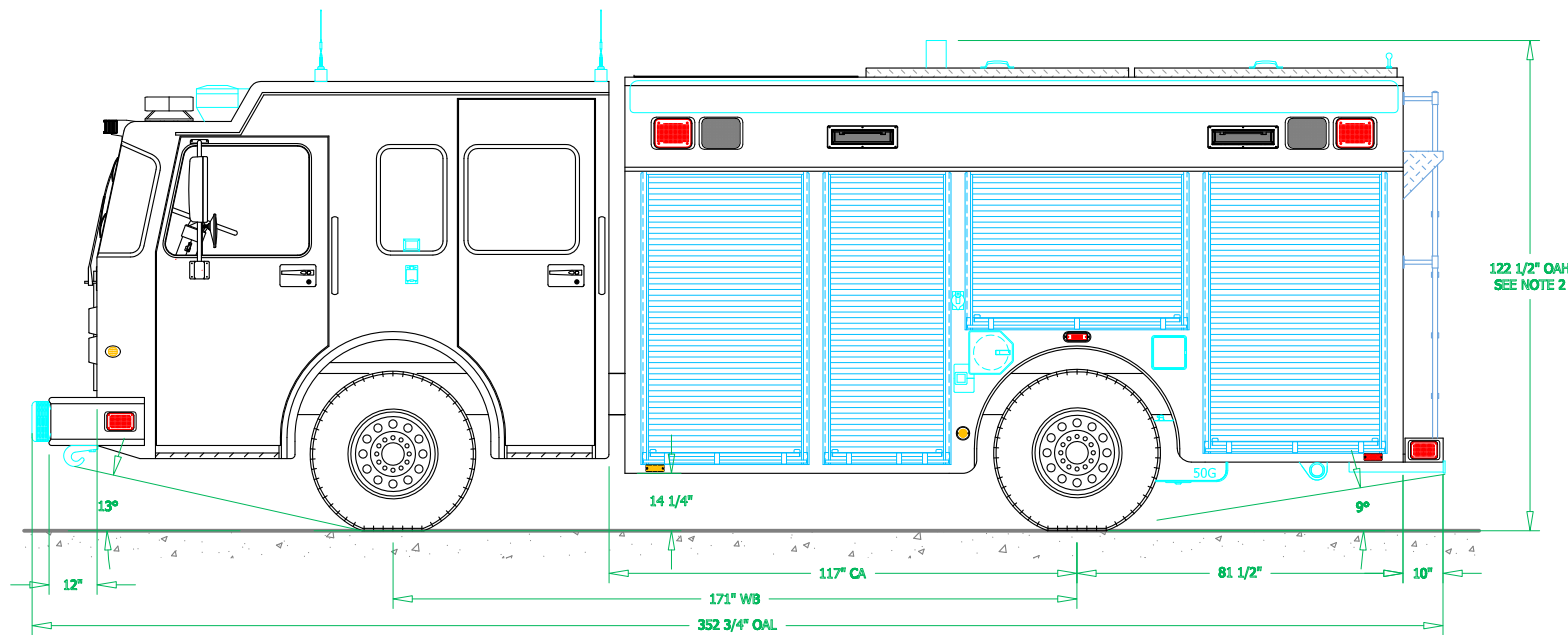
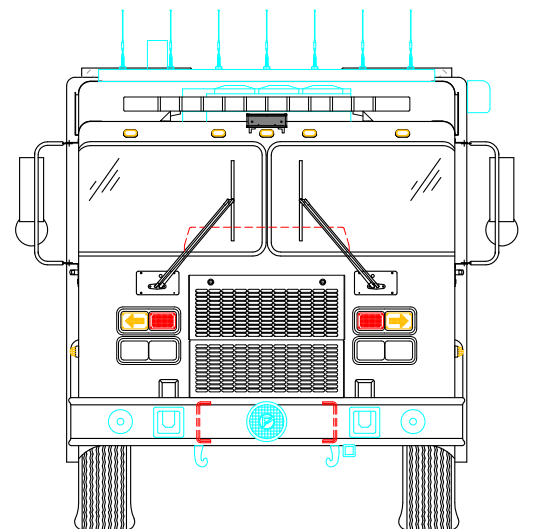
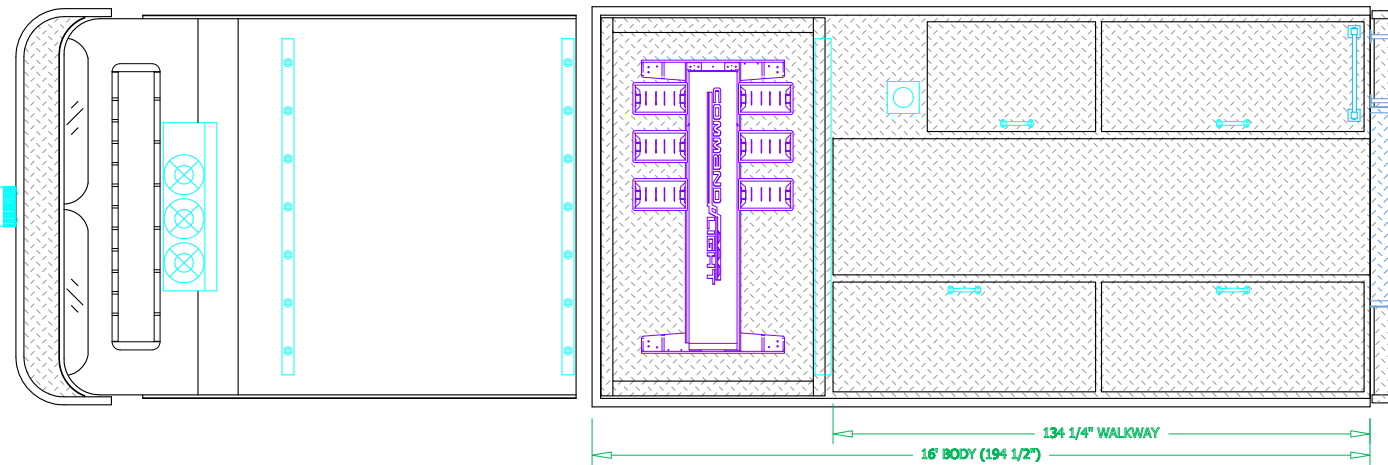

SVI FIRE & RESCUE TRUCKS  
1511 E. 11th STREET, LOVELAND, CO 80537 PHONE 970-667-5146, FAX 970-667-3343

## LYME FIRE DEPARTMENT

BODY SIZE: 16' BODY	UNIT TYPE: HEAVY RESCUE
BODY MATERIAL: 3/16" ALUMINUM	TRUCK NO:
CHASSIS TYPE: SPARTAN	WHEELBASE: 185 1/2"
BIG EASY MFD	CAB TO AXLE: 115"
4 DOOR	OVERALL LENGTH (OAL): 363"
10"RR	OVERALL WIDTH (OAW): 100"
	OVERALL HEIGHT (OAH): 117 1/4"

# DESIGN DRAWING

REVISIONS			
REV	DESCRIPTION	DATE	BY
A	PER CO #1	7/26/07	DLS

NOTE 1: Do not scale drawing. This drawing is for general truck configuration only. All items and dimensions shown are approximate and may vary with final production. The drawing may not provide illustration for all items in the specification. In all situations where the drawing may contradict the specifications, the specifications shall prevail. This drawing and all data herein are provided as confidential materials and shall not be reproduced without written consent of the manufacturer.

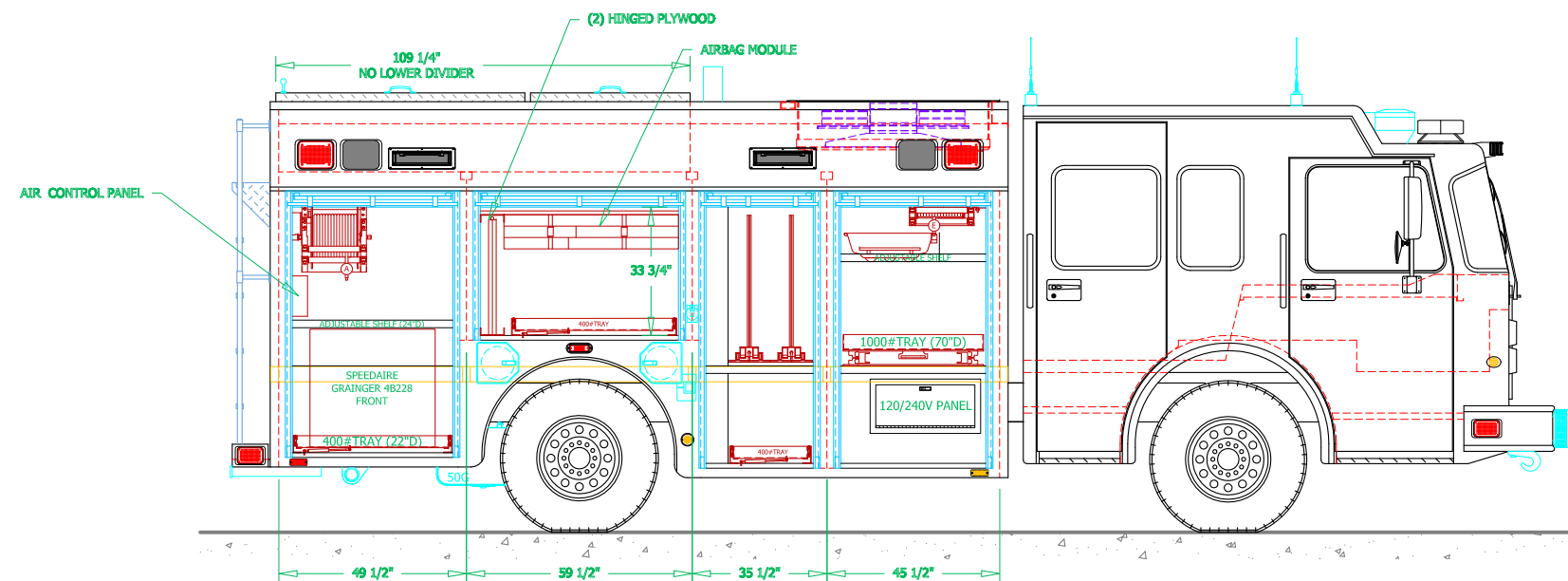
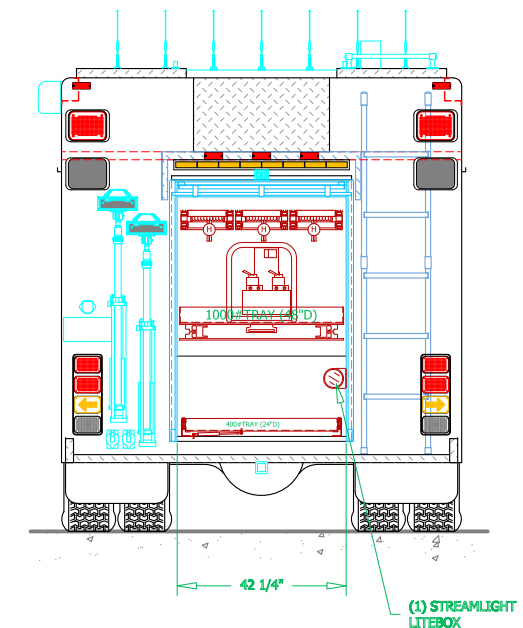
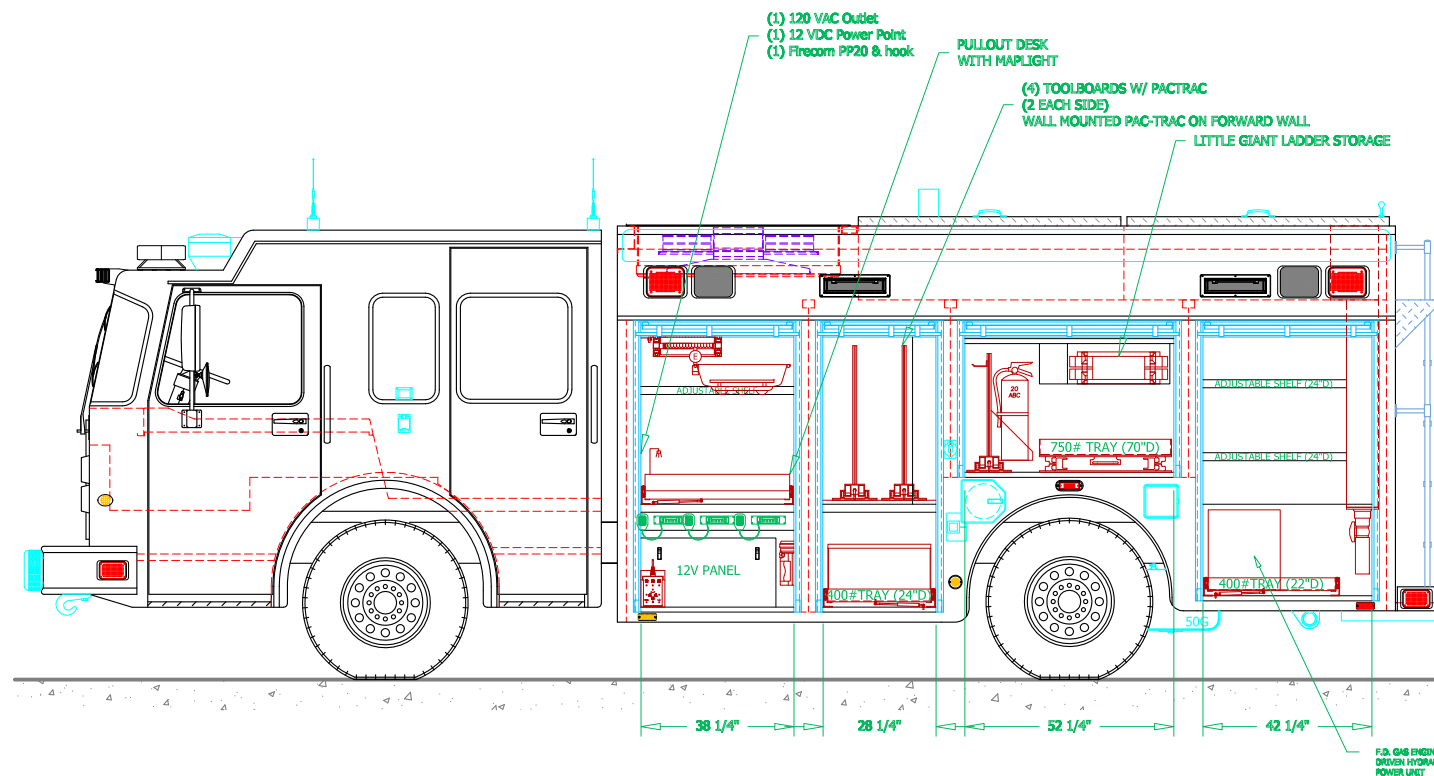
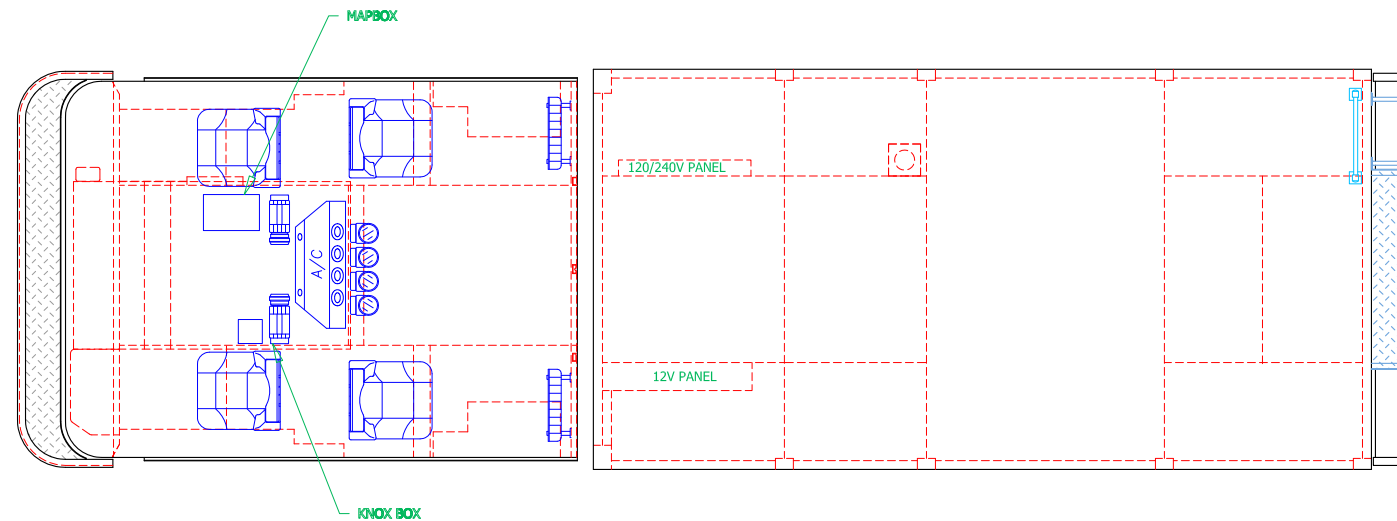

**SVI FIRE & RESCUE TRUCKS**  
1511 E. 11th STREET, LOVELAND, CO 80537 PHONE 970-667-5146, FAX 970-667-3343

**LYME FIRE DEPARTMENT**

DRAWN BY: JWG	DATE: SEPT. 19, 2007	SCALE: 1/4" = 1' - 0"
DRAWING NO: LYME_CT_HR_16_CO1.dwg	SHEET 2 OF 2	