

PROPOSAL DRAWING - FOR LAYOUT PURPOSES ONLY

REVISIONS			
REV	DESCRIPTION	DATE	BY

NOTE 1: Do not scale drawing. This drawing is for general truck configuration only. All items and dimensions shown are approximate and may vary with final production. The drawing may not provide illustration for all items in the specification. In all situations where the drawing may contradict the specifications, the specifications shall prevail. This drawing and all data herein are provided as confidential materials and shall not be reproduced without written consent of the manufacturer.

NOTE 2: Chassis frame height will change due to axle characteristics, loading and the dimensions which will effect the overall height dimension shown. Any overall height restrictions should take this into consideration and allow approximately 2-3 inches of tolerance.

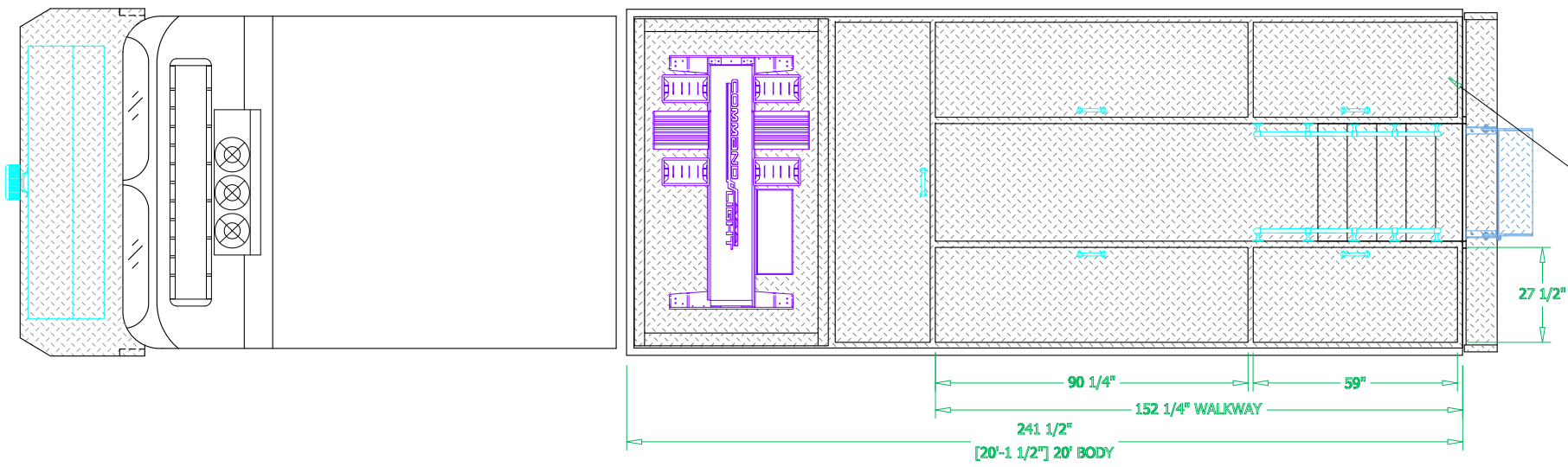

FLOOR DRY HOPPER LOCATED IN UPPER TUB COMPARTMENT

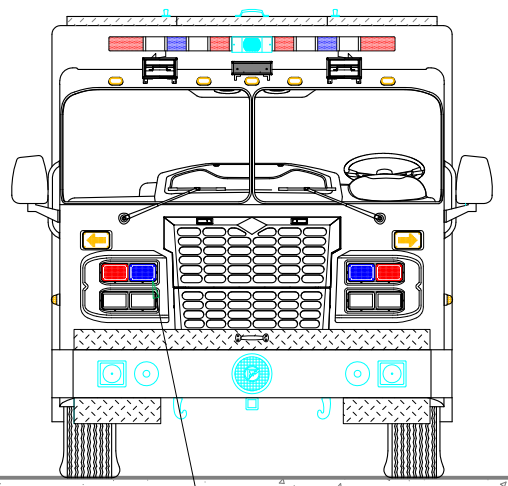

2 WHELEN 600 SERIES BLUE LED W/CLEAR LENS WARNING LIGHTS

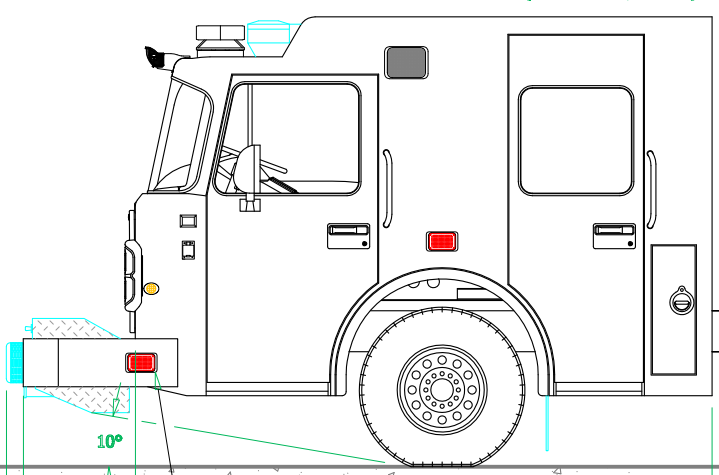

6 WHELEN 900 SERIES RED LED W/CLEAR LENS WARNING LIGHTS (2 EACH SIDE, 2 REAR)

10 WHELEN 600 SERIES RED LED W/CLEAR LENS WARNING LIGHTS (2 FRONT, 3 EACH SIDE, 2 REAR)

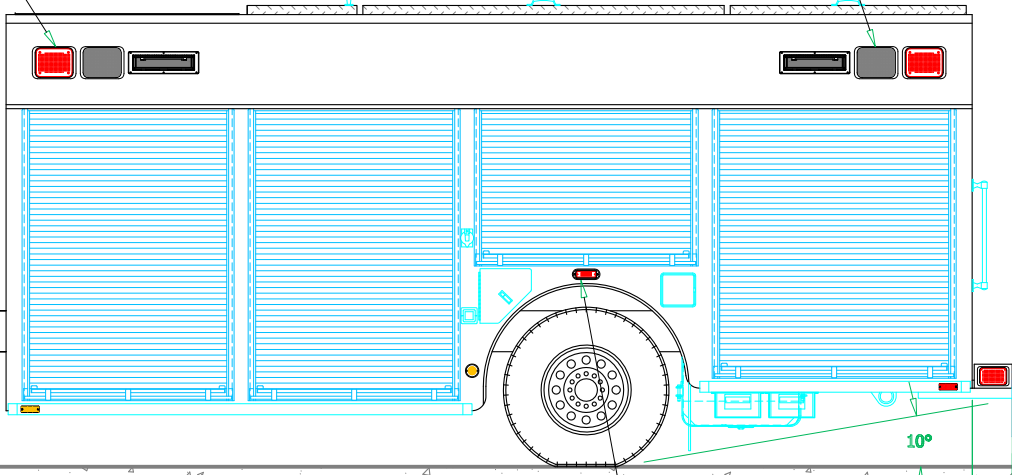

8 WHELEN 900 SERIES HALOGEN SCENE LIGHTS (3 EACH SIDE, 2 REAR)

2 WHELEN 900 SERIES BLUE LED W/CLEAR LENS WARNING LIGHTS (2 REAR)

215 1/2" WHEELBASE

431" [35'-11"] OAL

148" CA

96 1/2" (80" AF) 2 WHELEN 500 SERIES RED LED W/CLEAR LENS WARNING LIGHTS (1 EACH SIDE)

117" [9'-9"] OAH

21 3/4"

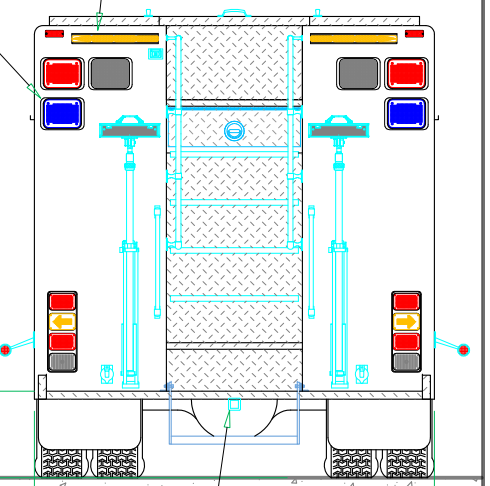

TOMAR SPLIT TRAFFIC ADVISOR

CLASS V HITCH

100" OAW

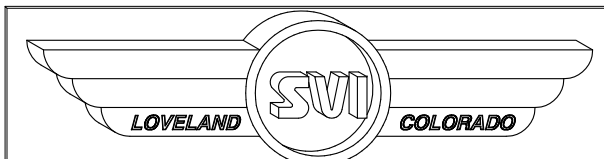
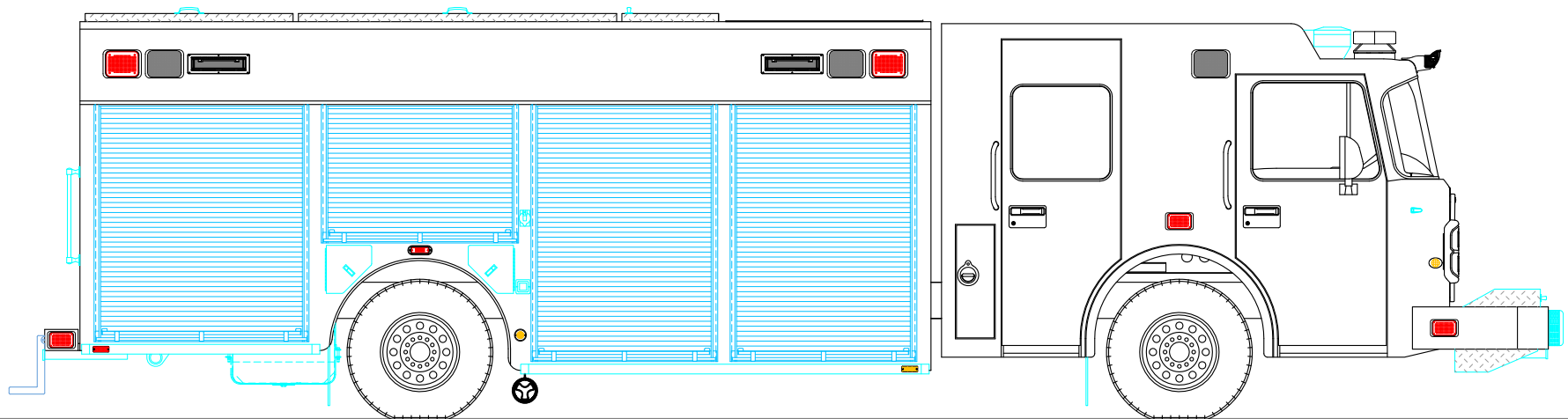

SVI FIRE & RESCUE TRUCKS  
1511 E. 11th STREET, LOVELAND, CO 80537 PHONE 970-667-5146, FAX 970-667-3343

CHERRY VALLEY  
FIRE PROTECTION DISTRICT

BODY SIZE: 20' BODY	UNIT TYPE: HEAVY RESCUE
BODY MATERIAL: ALUMINUM	TRUCK NO: SVI #xxx
CHASSIS TYPE: SPARTAN	WHEELBASE: SEE DWG
GLADIATOR LFD	CAB TO AXLE: SEE DWG
10" RR	OVERALL LENGTH (OAL): SEE DWG
FOUR DOOR	OVERALL WIDTH (OAW): SEE DWG
	OVERALL HEIGHT (OAH): SEE DWG

PROPOSAL DRAWING - FOR LAYOUT PURPOSES ONLY

REVISIONS			
REV	DESCRIPTION	DATE	BY

NOTE 1: Do not scale drawing. This drawing is for general truck configuration only. All items and dimensions shown are approximate and may vary with final production. The drawing may not provide illustration for all items in the specification. In all situations where the drawing may contradict the specifications, the specifications shall prevail. This drawing and all data herein are provided as confidential materials and shall not be reproduced without written consent of the manufacturer.

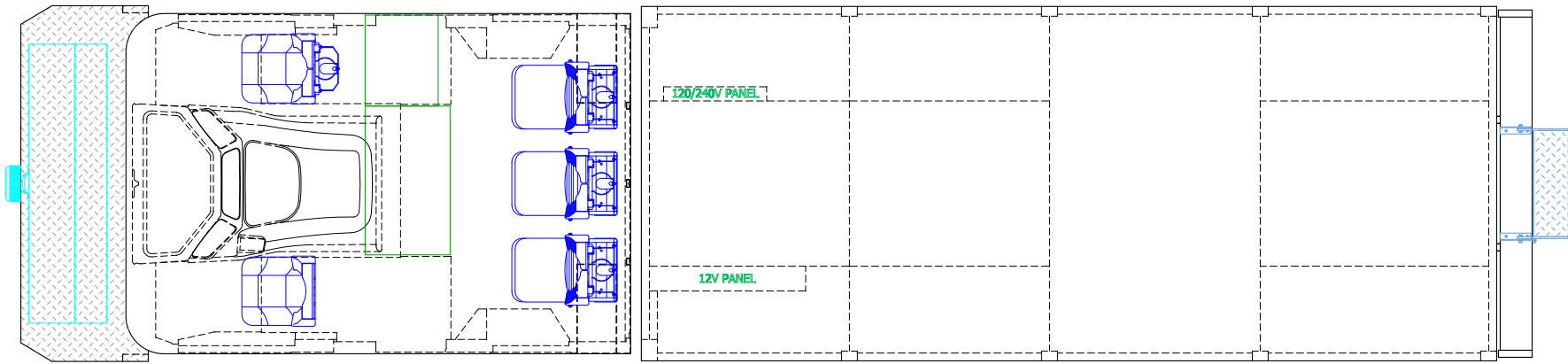

FRONT VIEW CROSS-SECTION

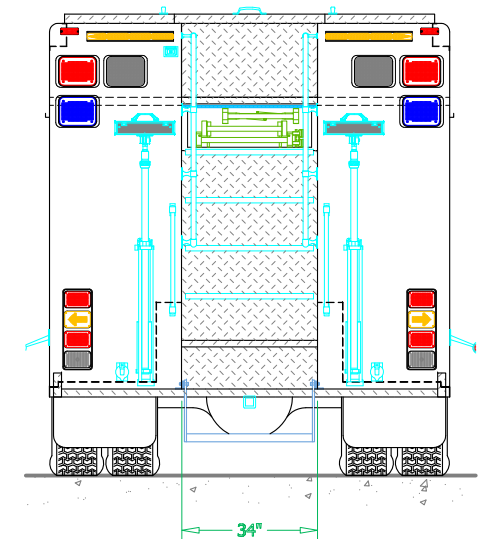
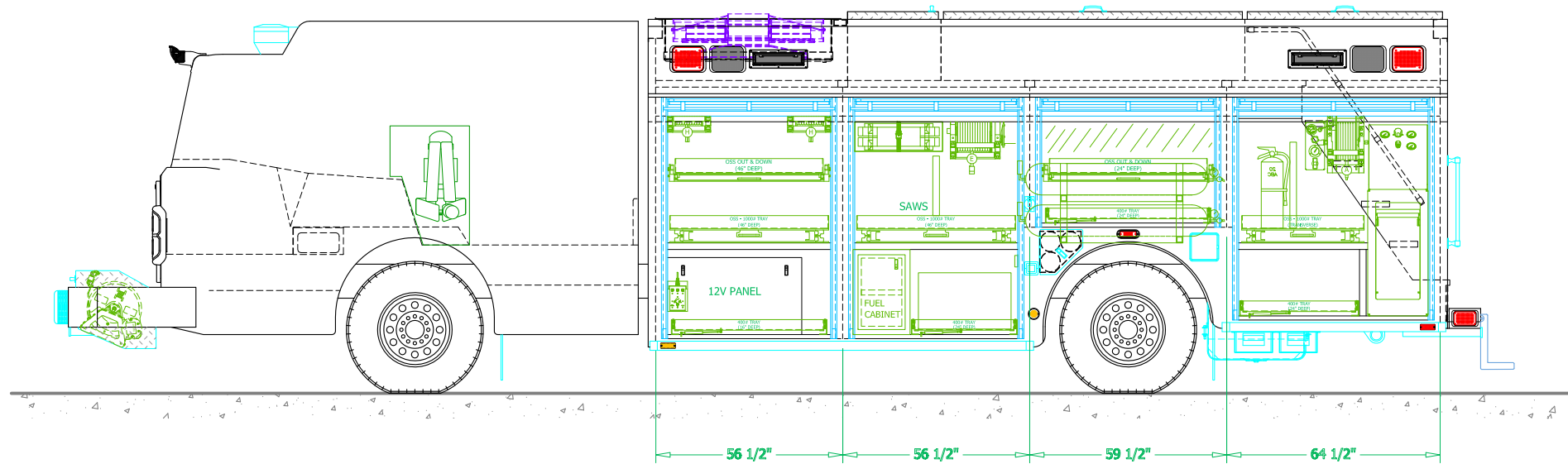
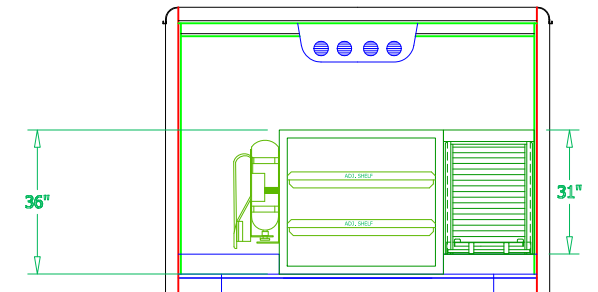

REAR VIEW CROSS-SECTION

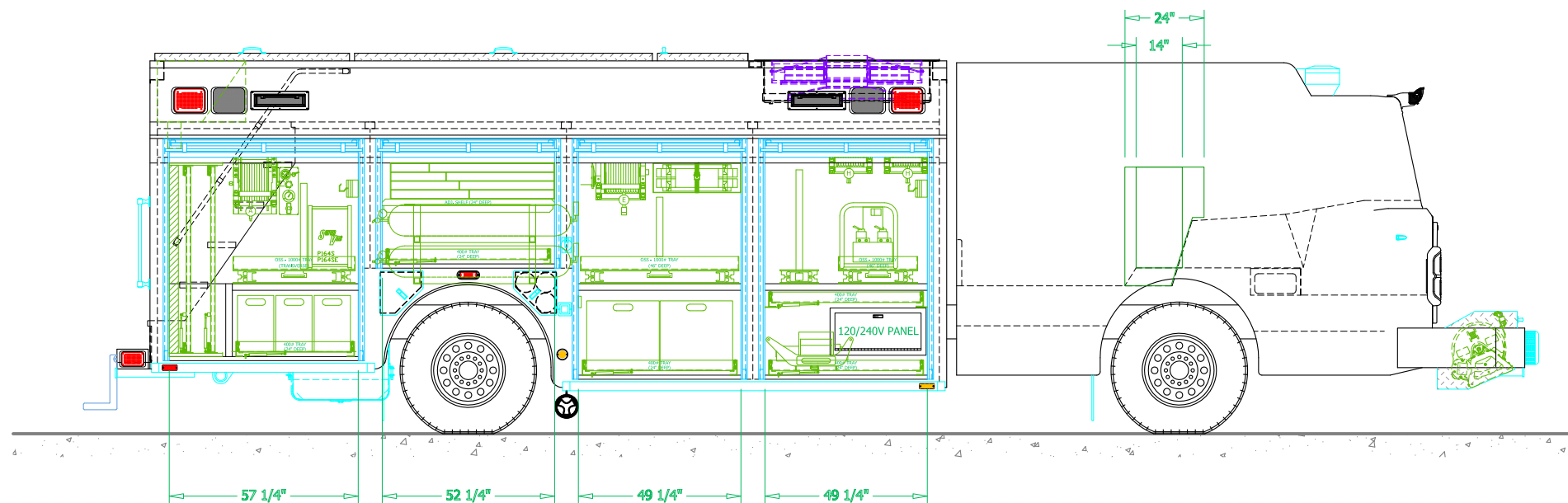



**LOVELAND SVI COLORADO**

**SVI FIRE & RESCUE TRUCKS**  
 1511 E. 11th STREET, LOVELAND, CO 80537 PHONE 970-667-5146, FAX 970-667-3343

**CHERRY VALLEY  
 FIRE PROTECTION DISTRICT**

DRAWN BY: HJR	DATE: November 10, 2009	SCALE: 1/4" = 1'-0"
DRAWING NO: CherryValley_IN_HR_PreCon	SHEET 2 OF 2	