

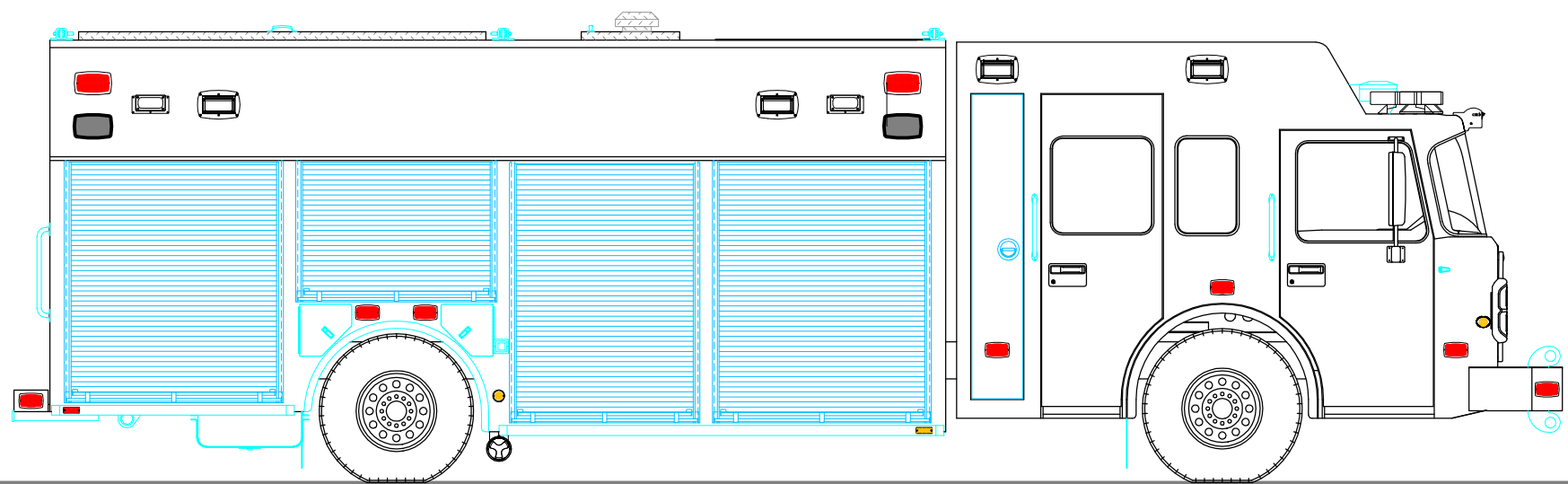
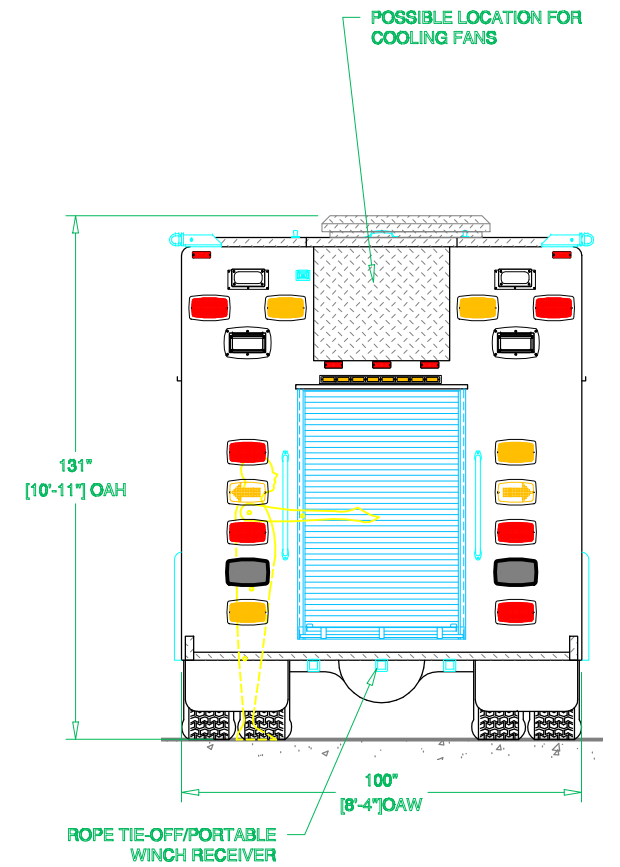
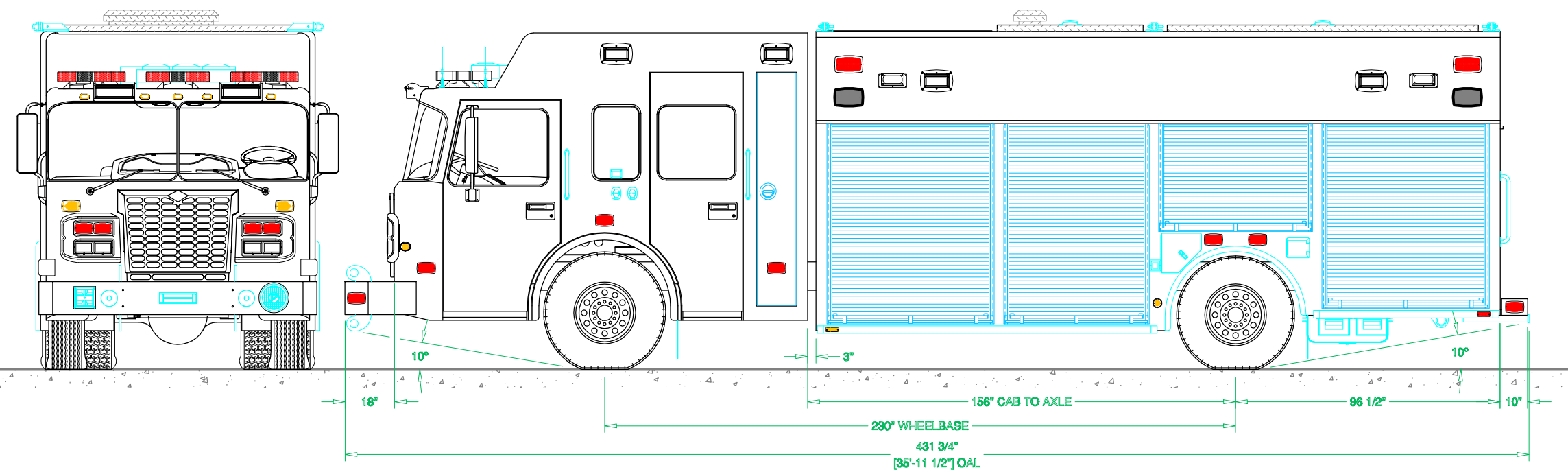
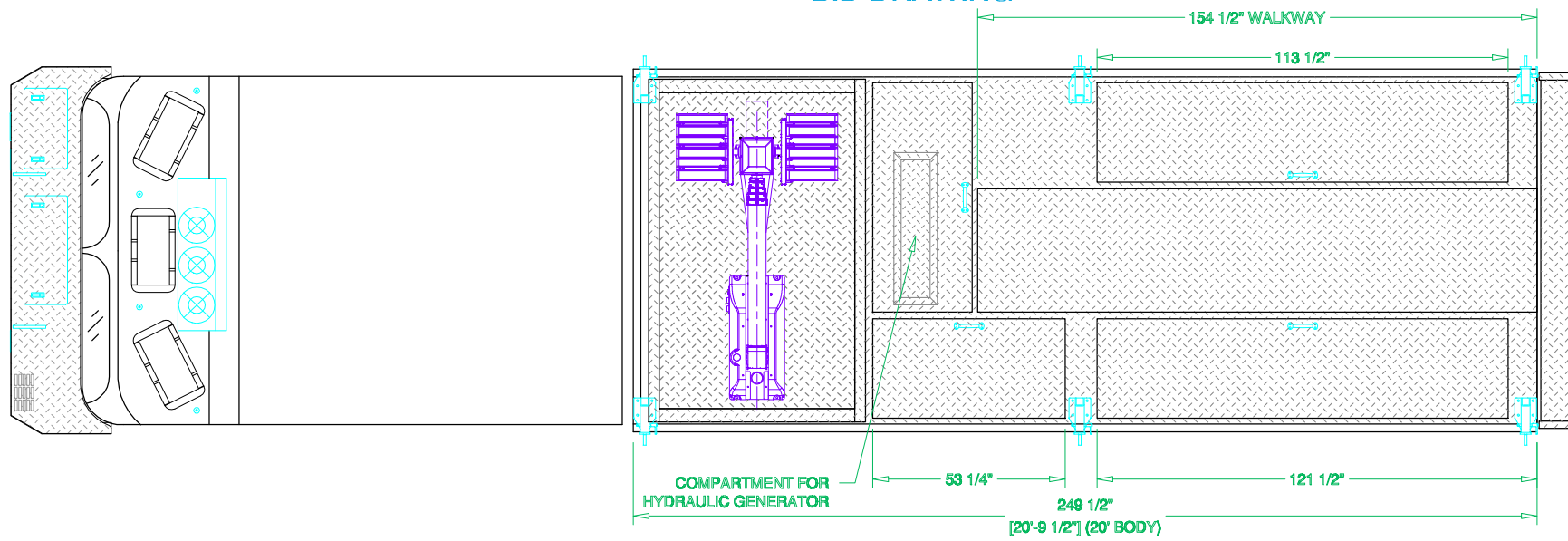

BID DRAWING

REVISIONS			
REV	DESCRIPTION	DATE	BY

NOTE 1: Do not scale drawing. This drawing is for general truck configuration only. All items and dimensions shown are approximate and may vary with final production. The drawing may not provide illustration for all items in the specification. In all situations where the drawing may contradict the specifications, the specifications shall prevail. This drawing and all data herein are provided as confidential materials and shall not be reproduced without written consent of the manufacturer.

NOTE 2: Chassis frame height will change due to axle characteristics, loading and tire dimensions which will effect the overall height dimension shown. Any overall height restrictions should take this into consideration and allow approximately 2-3 inches of tolerance.





LOVELAND SVI COLORADO

SVI FIRE & RESCUE TRUCKS
1511 E. 11th STREET, LOVELAND, CO 80537 PHONE 970-667-5146, FAX 970-667-3343

CLINTON VOLUNTEER FIRE DEPARTMENT

BODY SIZE: 20' BODY	UNIT TYPE: HEAVY RESCUE
BODY MATERIAL: 12 GA. STAINLESS STEEL	TRUCK NO: SVI #000
CHASSIS TYPE: SPARTAN	WHEELBASE: SEE DWG
GLADIATOR ELFD	CAB TO AXLE: SEE DWG
20" RR	OVERALL LENGTH (OAL): SEE DWG
FOUR DOOR	OVERALL WIDTH (OAW): SEE DWG
	OVERALL HEIGHT (OAH): SEE DWG

DRAWN BY: HJR DATE: July 26, 2012 SCALE: 1/4" = 1'-0"
DRAWING NO: Clinton_CT_hr20_PreCont SHEET 1 OF 2

BID DRAWING

REVISIONS			
REV	DESCRIPTION	DATE	BY

NOTE 1: Do not scale drawing. This drawing is for general truck configuration only. All items and dimensions shown are approximate and may vary with final production. The drawing may not provide illustration for all items in the specification. In all situations where the drawing may contradict the specifications, the specifications shall prevail. This drawing and all data herein are provided as confidential materials and shall not be reproduced without written consent of the manufacturer.

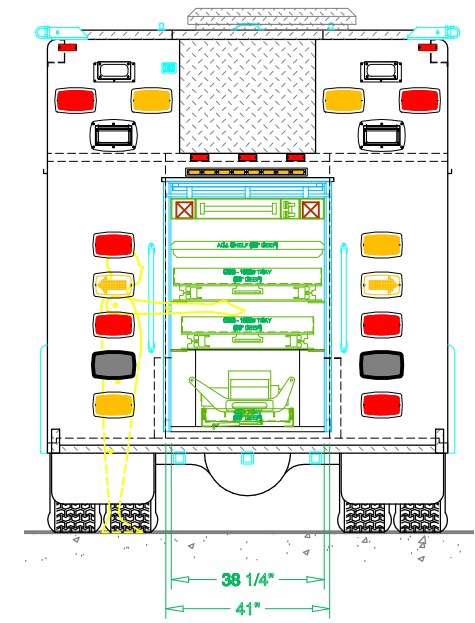
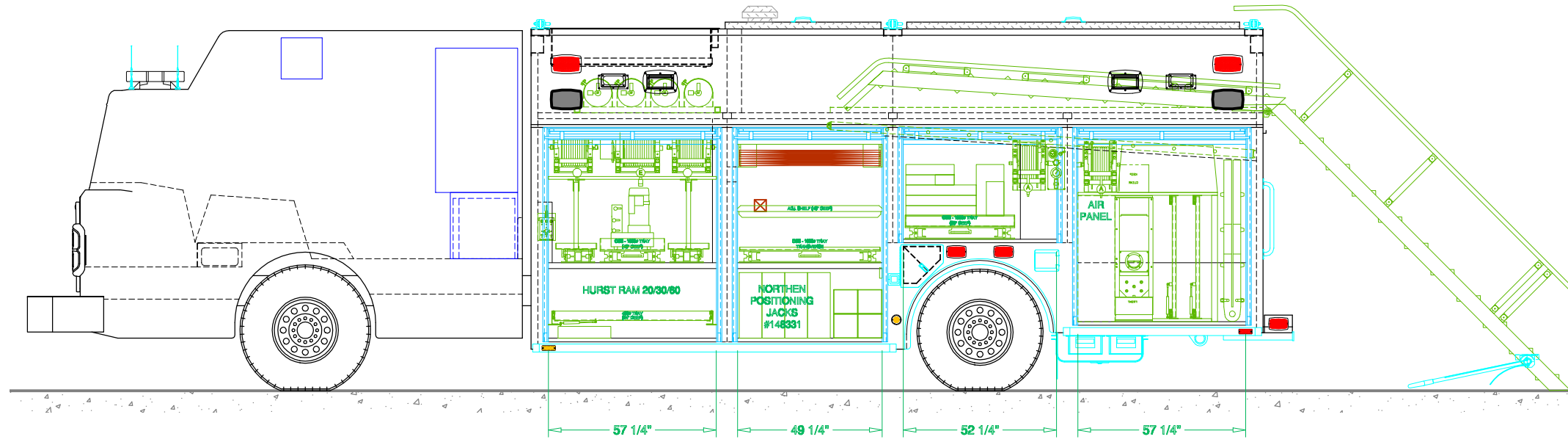
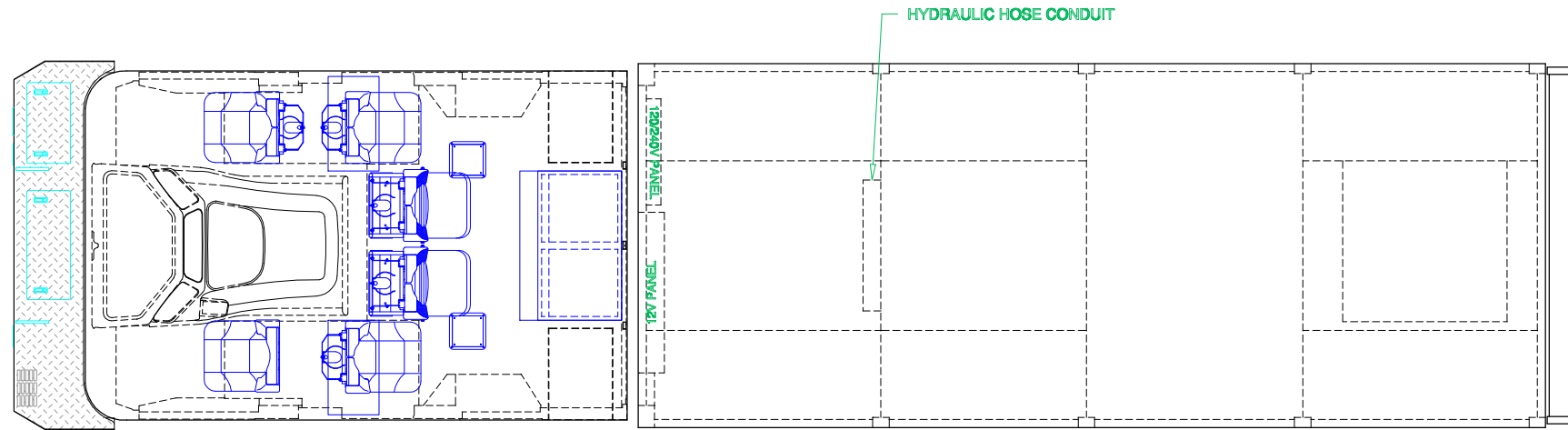

CHASSIS INTERIOR REAR CROSS-SECTION

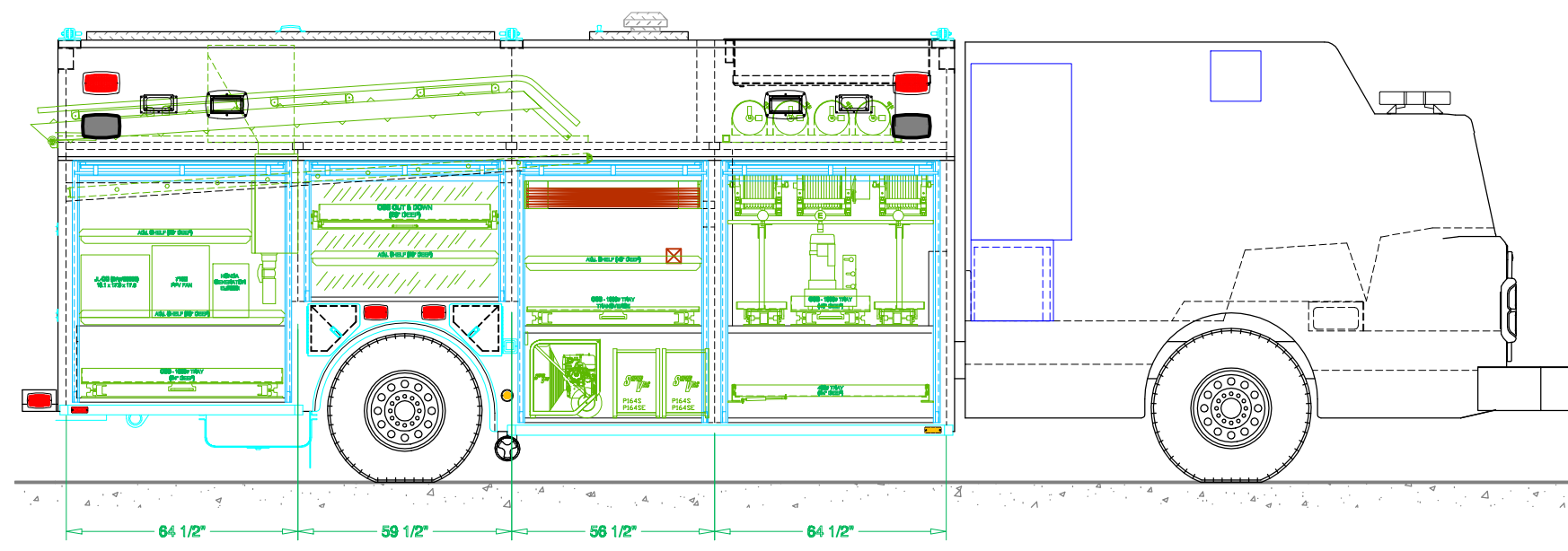

CHASSIS INTERIOR FRONT CROSS-SECTION

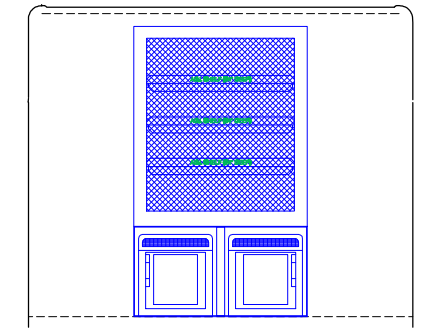
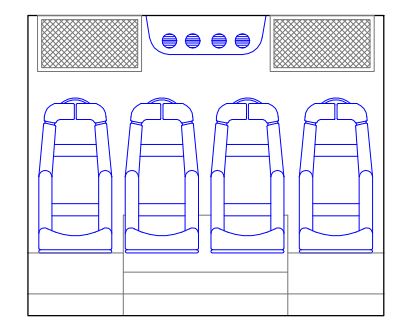

LOVELAND SVI COLORADO
SVI FIRE & RESCUE TRUCKS
 1511 E. 11th STREET, LOVELAND, CO 80537 PHONE 970-667-5146, FAX 970-667-3343
CLINTON VOLUNTEER FIRE DEPARTMENT

DRAWN BY: HJR DATE: Jul. 26, 12 SCALE: 1/4" = 1'-0"
 DRAWING NO: Clinton_CT_hr20_ProCont1 SHEET 2 OF 2