

PRELIMINARY DRAWING - FOR LAYOUT PURPOSES ONLY

REVISIONS			
REV	DESCRIPTION	DATE	BY

NOTE 1: Do not scale drawing. This drawing is for general truck configuration only. All items and dimensions shown are approximate and may vary with final production. The drawing may not provide illustration for all items in the specification. In all situations where the drawing may contradict the specifications, the specifications shall prevail. This drawing and all data herein are provided as confidential materials and shall not be reproduced without written consent of the manufacturer.

NOTE 2: Chassis frame height will change due to axle characteristics, loading and tire dimensions which will affect the overall height dimension shown. Any overall height restrictions should take this into consideration and allow approximately 2-3 inches of tolerance.

HOSE STORAGE TO BE DETERMINED

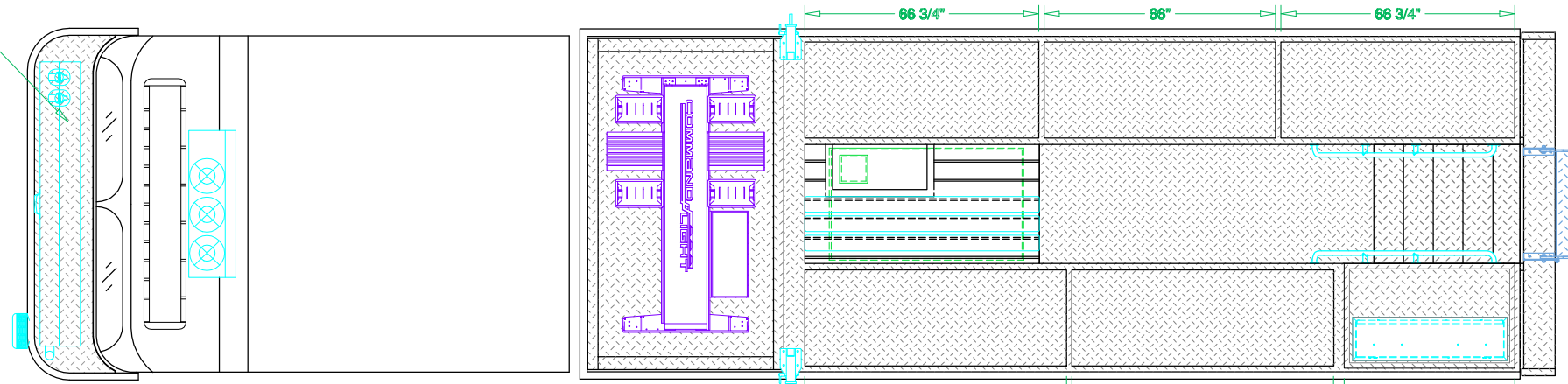

(6) WHELEN M9 SERIES RED LED WARNING LIGHTS (2 EACH SIDE, 2 REAR)

(2) FIRE RESEARCH SPECTRA SCENE LIGHTS (2 EACH SIDE)

(6) WHELEN M9 SERIES LED SCENE LIGHTS (2 EACH SIDE, 2 REAR)

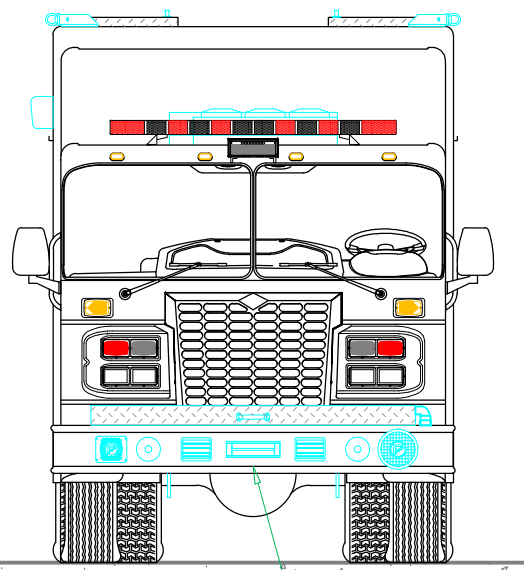

RAMSEY 15,000 lbs. WINCH

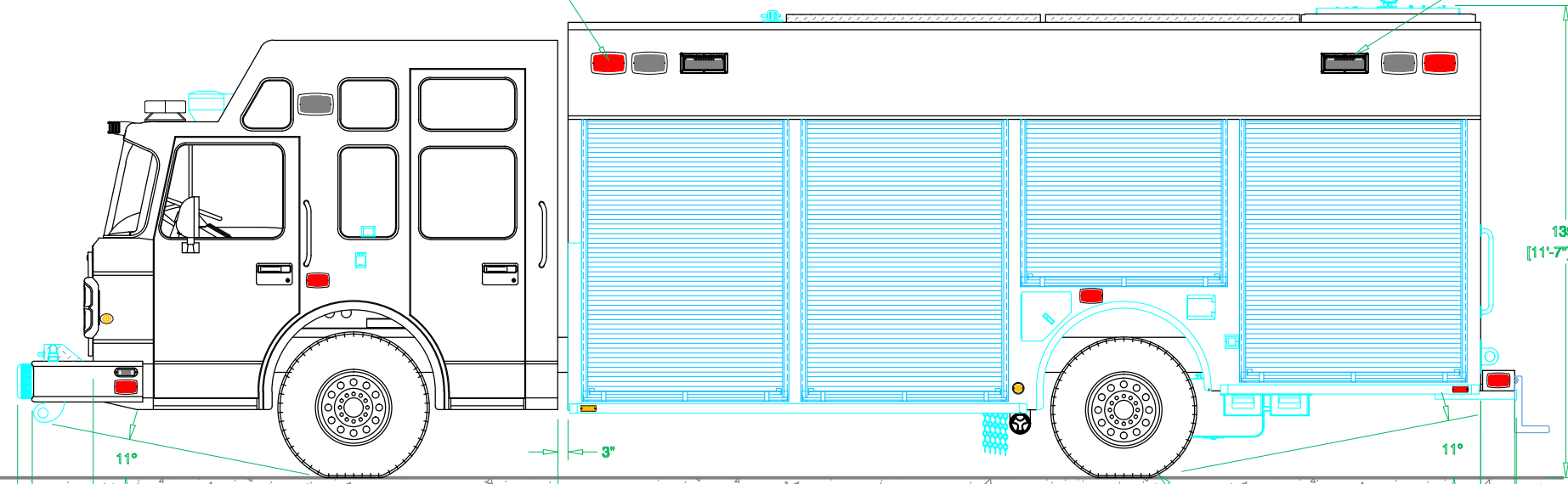

139" [11'-7"] OAH

105" (94 1/2 AF) REAR AXLE CAPACITY - MUST BE 31,000 lbs +

CLASS 3 TRAILER HITCH

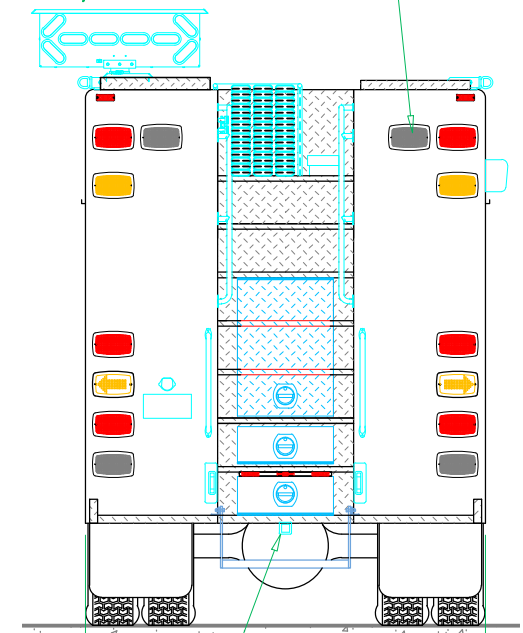

(8) WHELEN M6 SERIES RED LED LENS WARNING LIGHTS (4 EACH SIDE, 2 FRONT)

5000 lbs. MAX STRAIGHT PULL (BOTH SIDES)

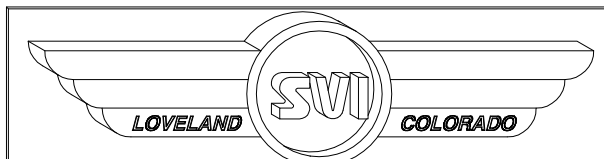
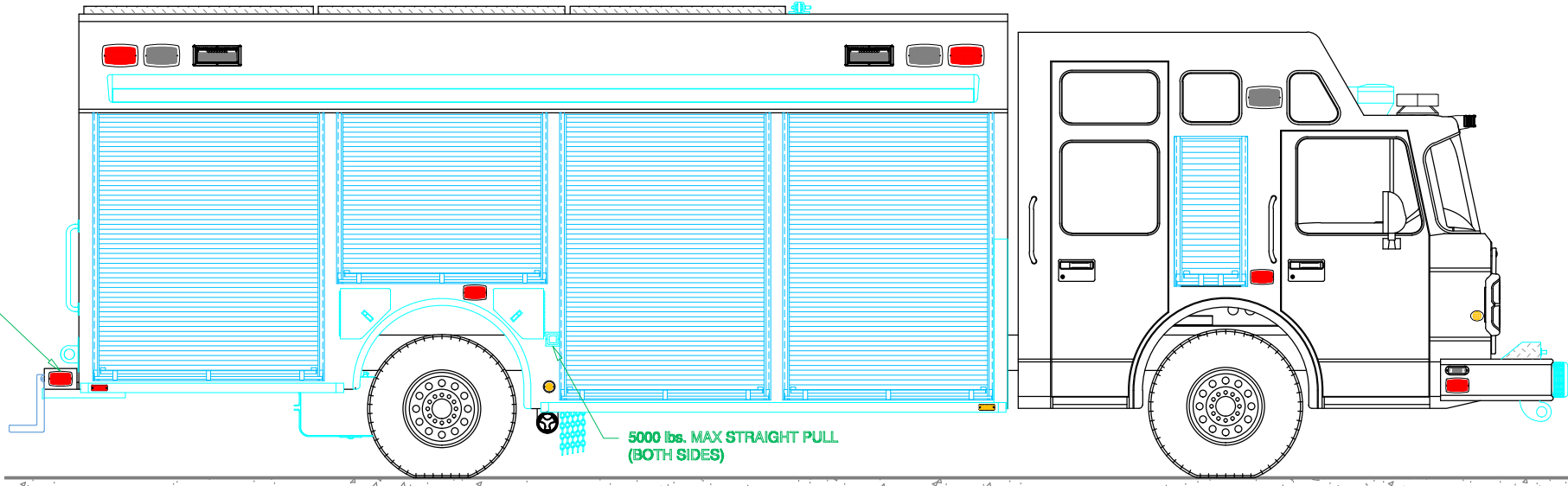

SVI FIRE & RESCUE TRUCKS  
1511 E. 11th STREET, LOVELAND, CO 80537 PHONE 970-667-5146, FAX 970-667-3343

COQUITLAM FIRE DEPARTMENT

BODY SIZE: 22' BODY	UNIT TYPE: HEAVY RESCUE
BODY MATERIAL: 3/16" ALUMINUM	TRUCK NO: SVI #000
CHASSIS TYPE: SPARTAN	WHEELBASE: SEE DWG
GLADIATOR MFD	CAB TO AXLE: SEE DWG
24" RR	OVERALL LENGTH (OAL): SEE DWG
FOUR DOOR	OVERALL WIDTH (OAW): SEE DWG
	OVERALL HEIGHT (OAH): SEE DWG

PRELIMINARY DRAWING - FOR LAYOUT PURPOSES ONLY

REVISIONS			
REV	DESCRIPTION	DATE	BY

NOTE 1: Do not scale drawing. This drawing is for general truck configuration only. All items and dimensions shown are approximate and may vary with final production. The drawing may not provide illustration for all items in the specification. In all situations where the drawing may contradict the specifications, the specifications shall prevail. This drawing and all data herein are provided as confidential materials and shall not be reproduced without written consent of the manufacturer.

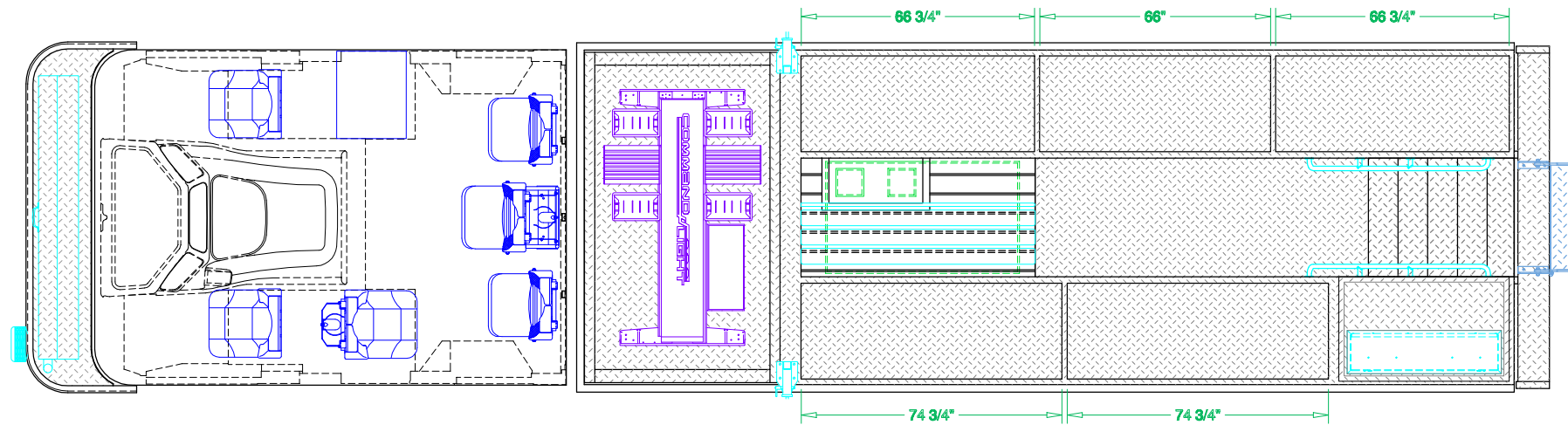

POSSIBLE TOOL BOARD & TRAY LAYOUT FOR S4

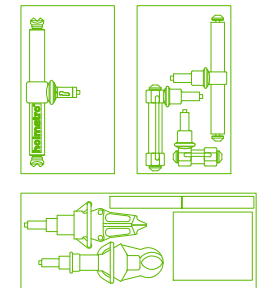

TOTAL CAPACITY - APPROX. 330 GALLONS

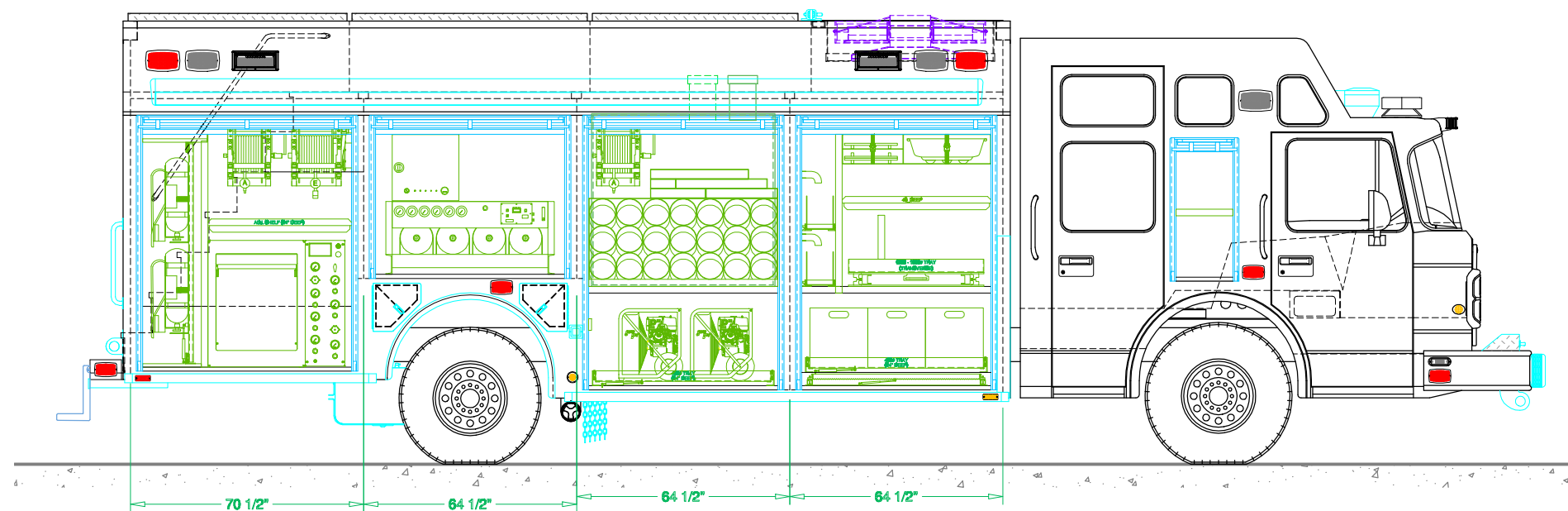
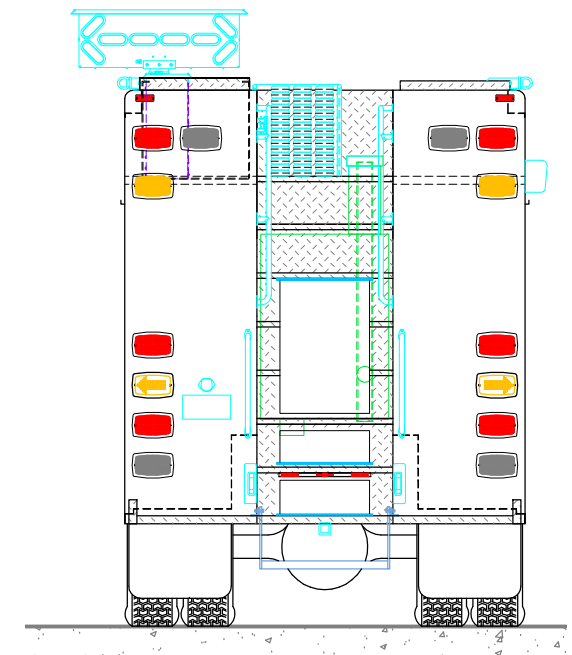
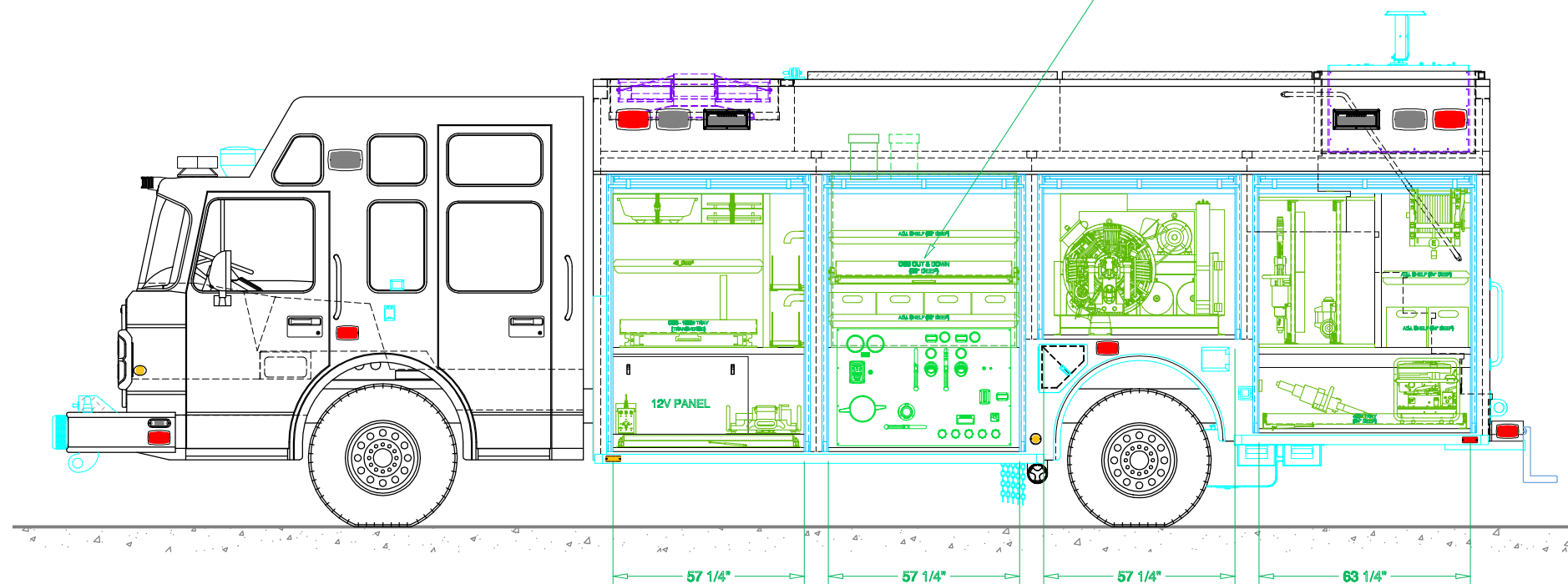

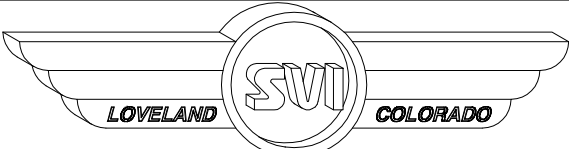

**LOVELAND SVI COLORADO**

**SVI FIRE & RESCUE TRUCKS**  
1511 E. 11th STREET, LOVELAND, CO 80537 PHONE 970-667-5146, FAX 970-667-3343

**COQUITLAM FIRE DEPARTMENT**

DRAWN BY: HJR	DATE: January 16, 2013	SCALE: 1/4" = 1'-0"
DRAWING NO: Coquitlam_BC_hr_PCM3	SHEET 2 OF 2	