



## **SVI Truck# 1025-Loveland Fire Rescue Authority**

### **Chassis**

Cab: Spartan Gladiator LFD w/ 10" RR  
Engine: Cummins L9, 450HP  
Transmission: Allison EVS 3000  
Wheelbase: 180"

### **Body**

Material: Aluminum  
Body Length: 14'  
Overall Height: 10' 10"  
Overall Length: 31.5'

### **Features**

Waterous 1500 GPM fire pump, 500 gallon tank  
OnScene Solutions LED Compartment Lights  
Whelen LED Warning Light Package  
Akron Deck Gun  
Command Light Shadow RT LED Light Tower  
FoamPro 2001 foam proportioning system  
Hannay 100' of 3 / 4" Booster Hose Reel



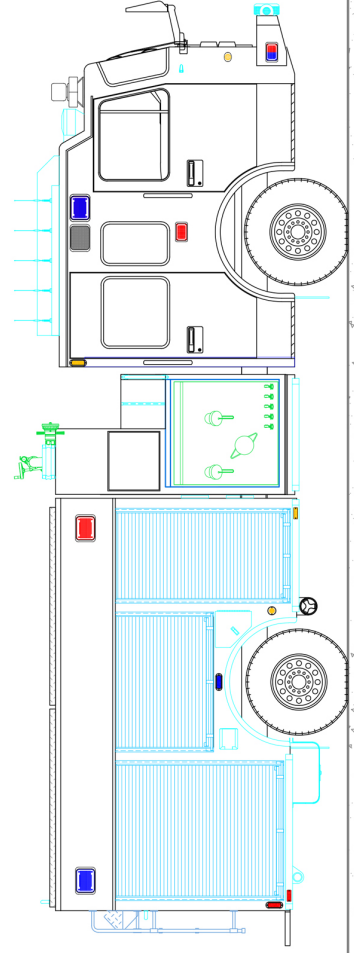
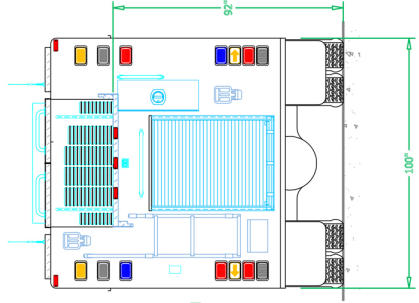
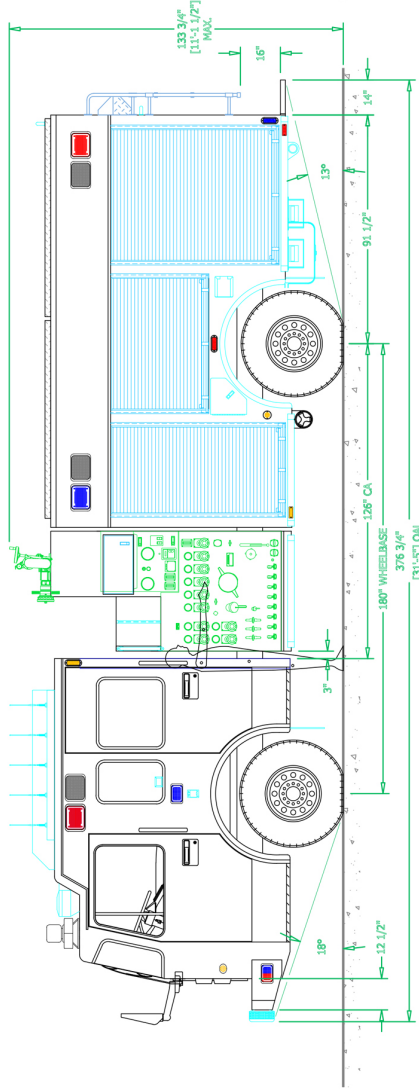
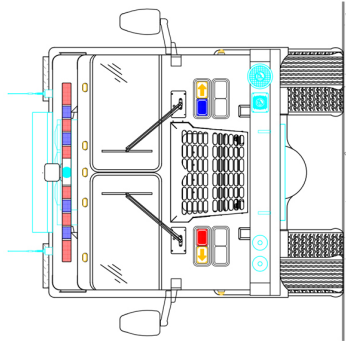
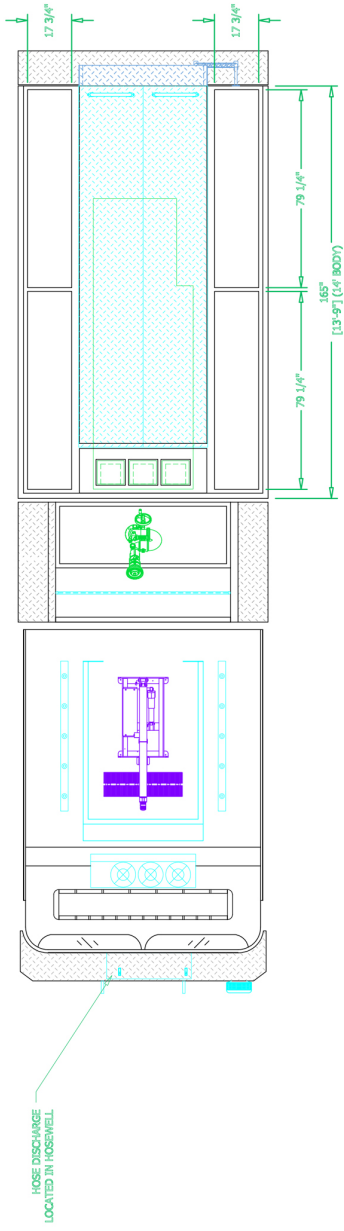

See more at [svitrucks.com](http://svitrucks.com)