



Kremmling Type 6 Brush Truck #1061

Chassis

Cab: Ford F-550 Super Duty Extended Cab
Engine: 6.7L Power Stroke Turbo Diesel
Transmission: Ford HD TorqShift Automatic
Wheelbase: 204"

Body

Material: 1/8" Aluminum
Body Length: 10' 10"
Overall Height: 7' 11"
Overall Length: 26'

Features

24 HP Honda Engine with Mercedes Centrifugal Pump
Whelen Pioneer 12 VDC, 75-Watt, Flood/Spot LED
300-Gal Poly Tank with Removable Top
FoamPro 1600 Series Foam System
OnScene Solutions Aluminum Slideout Cargo Trays
ROM Series IV Roll-Up Exterior Compartment Doors
OnScene Solutions LED Compartment Lights

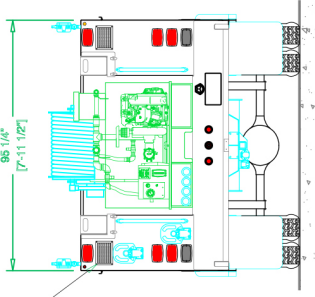

(2) WHELEN PIONEER PCPSM/C
FLUSH MOUNT SPOT/FLOODLIGHTS
(1 EACH SIDE)

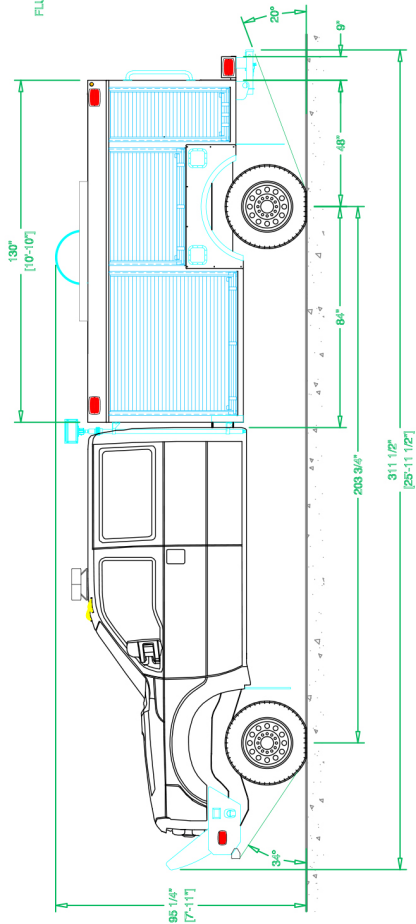

95 1/4" [7'-11"]

(2) AKRON SCENESTAR PUSH-UP POLE LIGHTS (1 EACH SIDE)

(2) RIGID IND. 50" LIGHT BARS
COMBO SPOT/FLOODLIGHTS (1 EACH SIDE)

BUCKSTOP BOSS FRONT
BUMPER EXTENSION

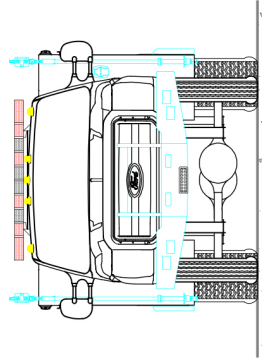
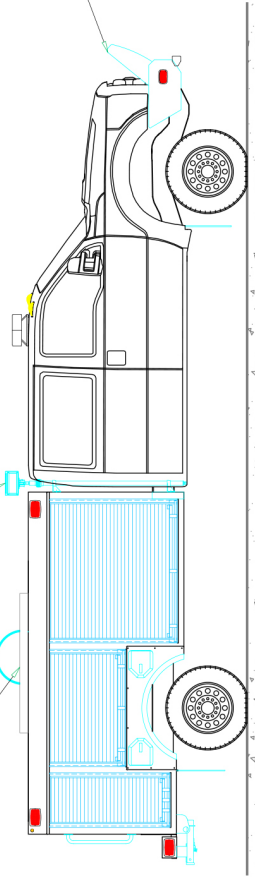

See more at svitrucks.com