



Cairo, NY Fire District Pumper #1129

Chassis

Cab: Spartan Gladiator EMFD with 10" RR
Engine: Cummins X15 600 HP
Transmission: Allison EVS 4000
Wheelbase: 190"

Body

Material: Aluminum
Body Length: 13'
Overall Height: 9' - 11"
Overall Length: 33'

Features

TFT Hurricane 1,250-GPM Deck Gun with Remote Control
1,500-Gal. Poly Water Tank
FRC Throttle Xcel Engine Throttle and Monitoring Display
Two-Section Aluminum Hose Bed Cover
Will-Burt Night Scan Powerlite Series Light Tower
OnScene Solutions LED Compartment Lighting
Whelen LED Directional Traffic Warning
Hannay Booster Hose Reel with Power Rewind
Wabco® SS318 Single Cylinder Air Compressor
Heavy-Duty Swing-Out Tool Board

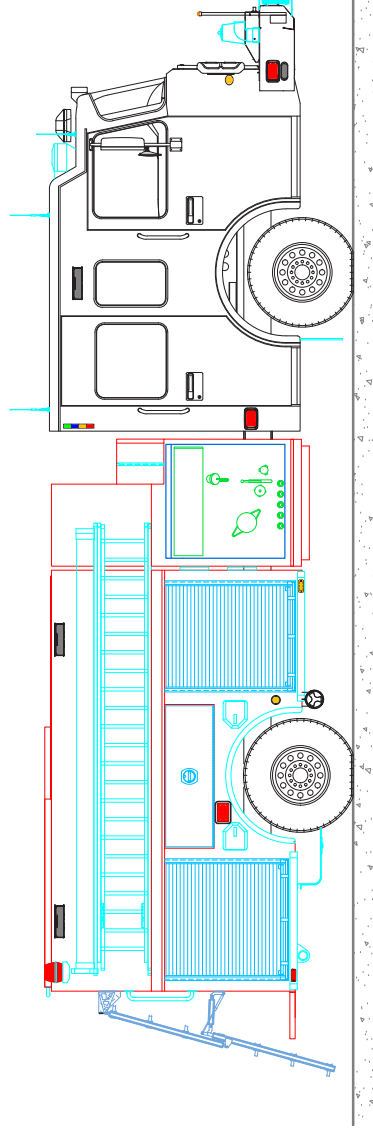
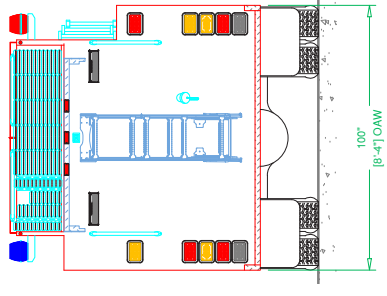
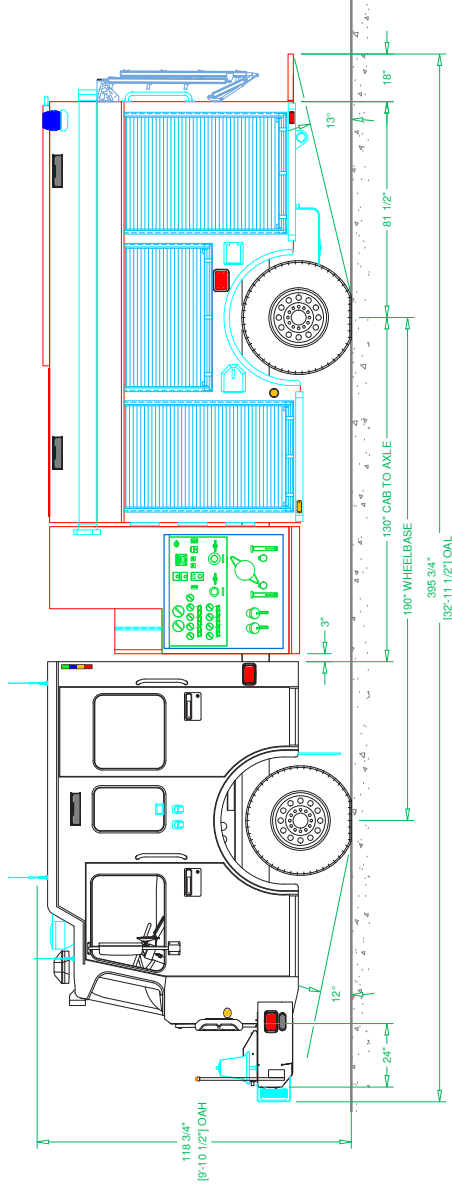
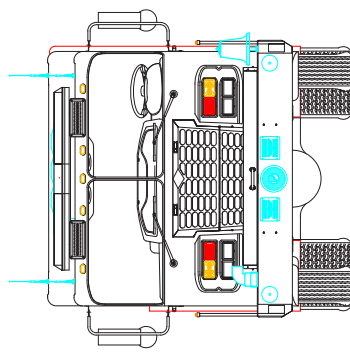
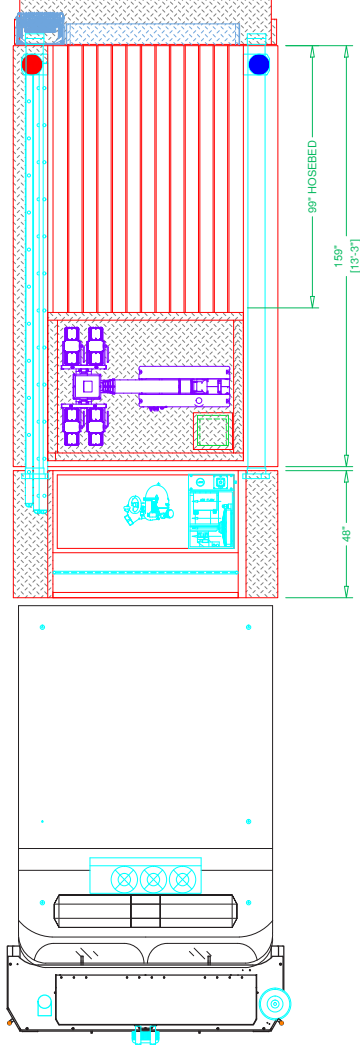

See more at svitrucks.com