



## Eaton, CO Wildland Type 4 Engine #1124

### Chassis

Cab: International HV507 4x4 4-Door  
Engine: Cummins L9 380 HP  
Transmission: Allison 3000 EVS 6 SPD  
Wheelbase: 203"

### Body

Material: Aluminum  
Body Length: 12'  
Overall Height: 10' - 6"  
Overall Length: 27' - 2"

### Features

Darley HSE 250K Diesel Engine Pump  
750-Gal. Poly Water Tank  
FoamPro 1601 Foam System  
Remote-Controlled Deck Gun  
Front-Bumper Ground-Sweep Snozzles  
Rear-Door Pump Access  
OnScene Solutions Cargo Slides and Compartment Lighting  
Trident Emergency Products AirPrime System  
Whelen LED Warning and Scene Lighting Package  
Hannay SBEF Series Booster Hose Reel

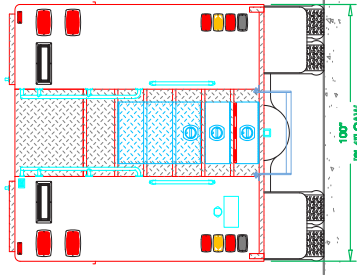
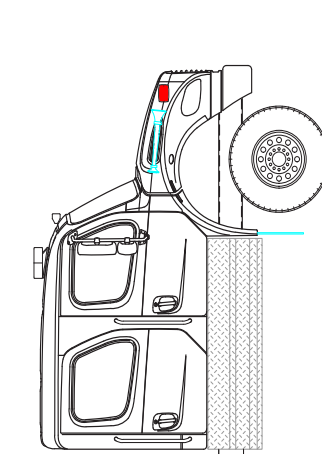
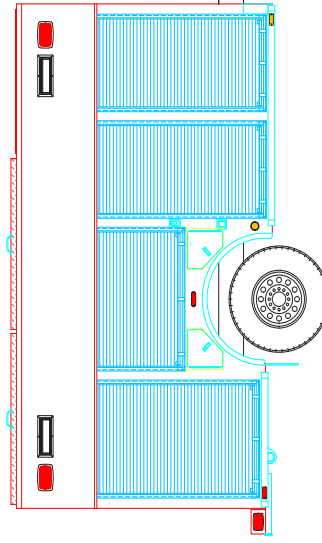
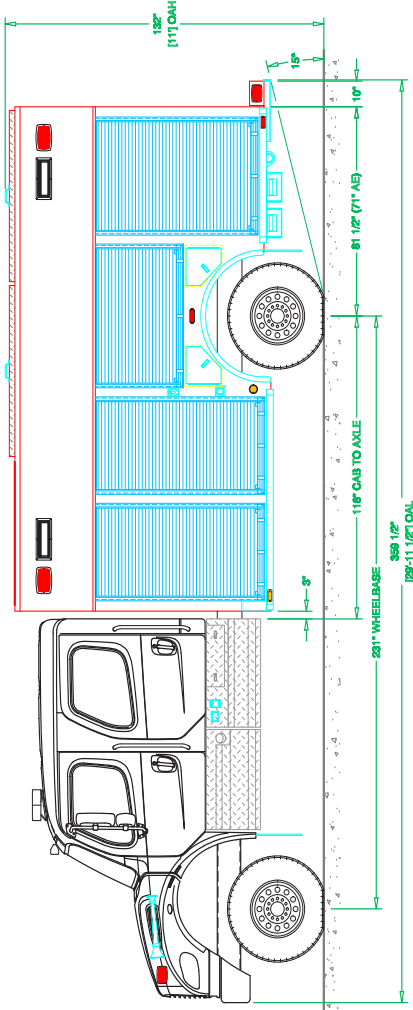
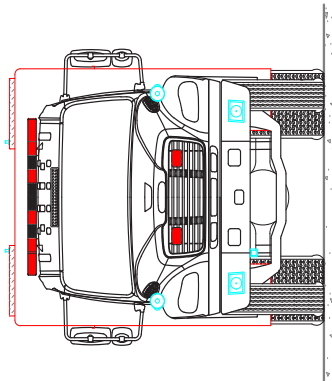
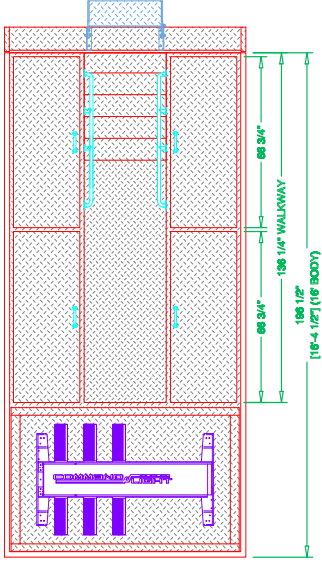
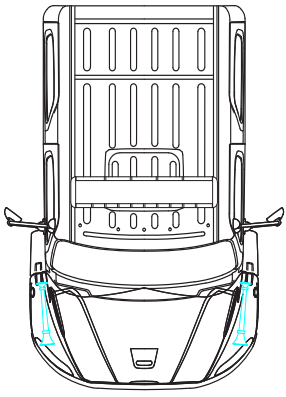

See more at [svitrucks.com](http://svitrucks.com)