



Athens, MI Heavy Rescue #1131

Chassis

Cab: Spartan Gladiator LFD 20" RR
Engine: Cummins L9 450 HP
Transmission: Allison EVS 3000
Wheelbase: 202"

Body

Material: Aluminum
Body Length: 18'
Overall Height: 10' - 10"
Overall Length: 32' - 11"

Features

Chelsea Heavy-Duty Transmission Driven PTO
12V Multiplex Control Center
FRC Spectra Surface Mount LED Lights
Whelen LED Warning and Light Package
ROM Series IV Roll-Up Doors
Crew Area Interior Storage Cabinets
(5) Upper Body Storage Compartments
OnScene LED Compartment Lighting
Slideout Aluminum Vertical Tool Boards
OnScene Solutions Aluminum Heavy-Duty Cargo Slides
Lista Drawer Cabinet

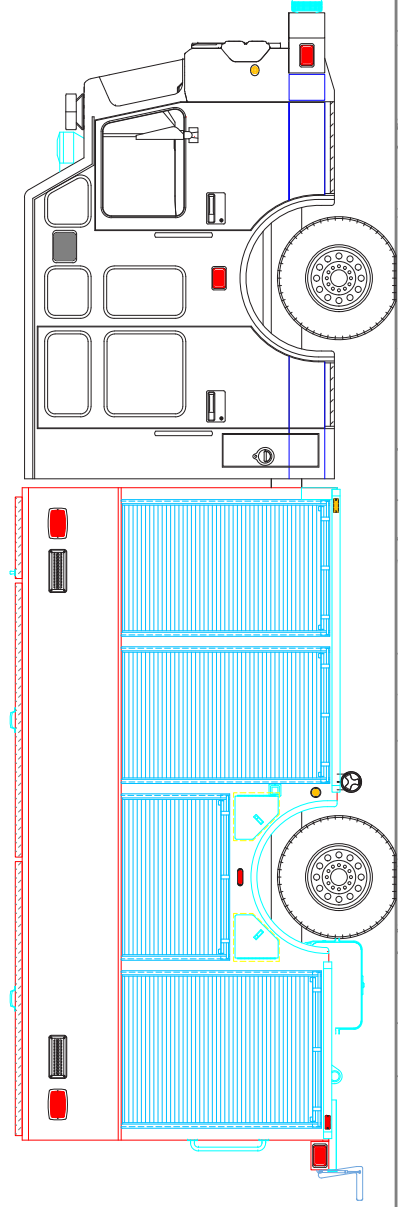
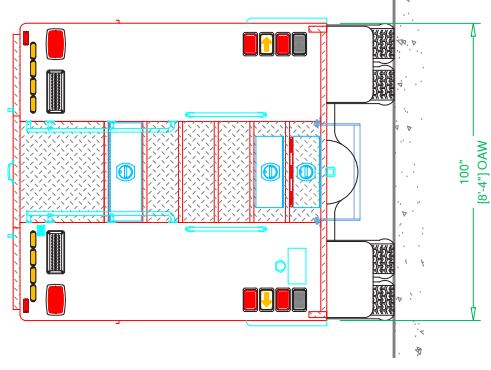
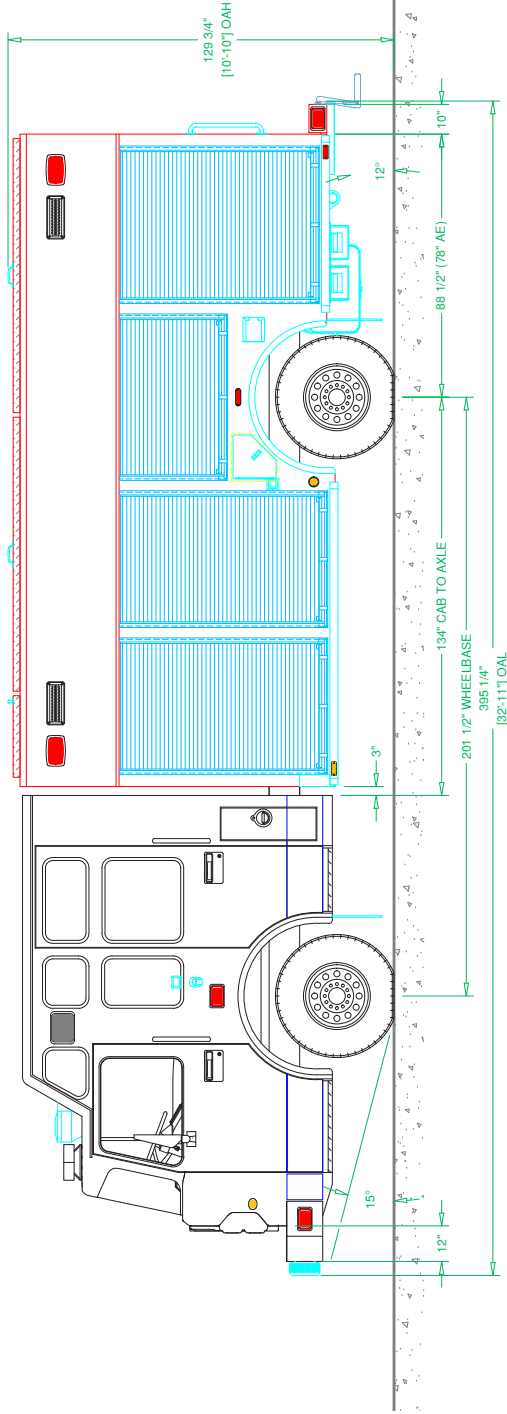
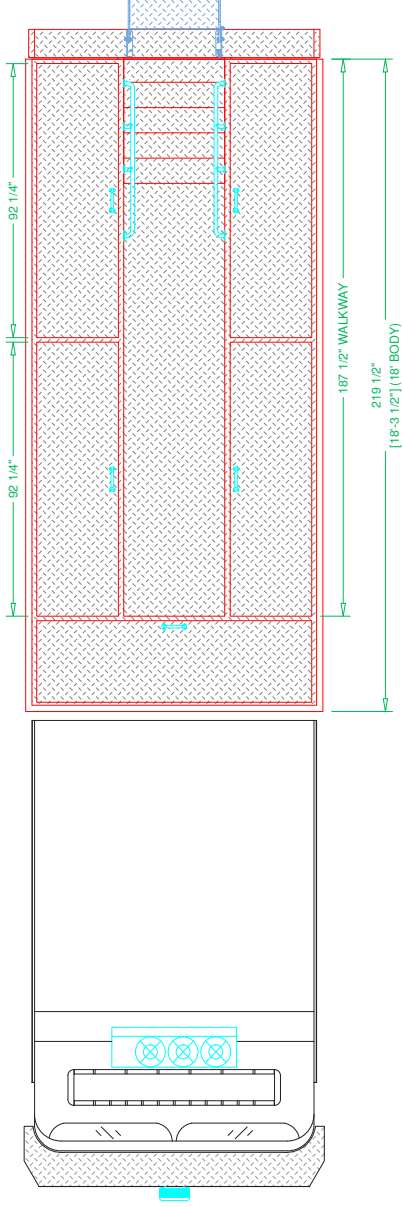

See more at svitrucks.com